

# OVERHEAD LIFTING

Grade 80 & 100 Alloy Chain .....	5
Chain Sling Information .....	6-7
Accoloy-Kuplex Alloy Accessories .....	8-15
V10 Alloy Accessories .....	16-26
Peer-Lift Alloy Accessories .....	27-29
Identification Tags .....	29
Custom Lifting .....	30-49
Web Slings .....	50-55





## Alloy Chain

Peerless alloy chain is rugged, versatile, high-strength, low-weight chain manufactured from special analysis alloy steel. It is quenched and tempered before proof testing and the ultimate tensile strength is over twice that of ordinary steel chain. Tensile strength following heat treatment meets or exceeds all existing OSHA, Government, NACM and ASTM specification requirements.

### G80 Alloy Chain - Full Drum

Stock #	Trade Size		Wire Dia. (inches)	Inside Link Dim. (In.)		Ft. Per Drum	Net Wt. (Lbs.)	WLL	
	Inches	MM		Length (Nominal)	Width (Min)			Lbs.	Kgs.
Black									
5050223	9/32	7	0.279	0.827	0.405	800	610	3,500	1,588
5050323	5/16	8	0.310	0.945	0.480	500	457	4,500	2,041
5050423	3/8	10	0.392	1.182	0.560	500	737	7,100	3,221
5050623	1/2	13	0.516	1.535	0.750	300	743	12,000	5,443
5050823	5/8	16	0.630	1.890	0.902	200	725	18,100	8,210
5050923	3/4	20	0.781	2.420	1.140	100	575	28,300	12,837
5051023	7/8	22	0.906	2.660	1.260	100	793	34,200	15,513
5051123	1	26	1.032	2.900	1.420	50	520	47,700	21,636
5051223*	1-1/4	32	1.260	3.780	1.640	66	1,023	72,300	32,795

\*Sourced by Peerless Industrial Group



### G80 Alloy Chain - Half Drum

Stock #	Trade Size		Wire Dia. (inches)	Inside Link Dim. (In.)		Ft. Per Drum	Net Wt. (Lbs.)	WLL	
	Inches	MM		Length (Nominal)	Width (Min)			Lbs.	Kgs.
Black									
5050224	9/32	7	0.279	0.827	0.405	400	305	3,500	1,588
5050324	5/16	8	0.310	0.945	0.480	250	229	4,500	2,041
5050424	3/8	10	0.392	1.182	0.560	250	369	7,100	3,221
5050624	1/2	13	0.516	1.535	0.750	150	372	12,000	5,443

### G100 Alloy Chain - Full Drum

Stock #	Trade Size		Wire Dia. (inches)	Inside Link Dim. (In.)		Ft. Per Drum	Net Wt. (Lbs.)	WLL	
	Inches	MM		Length (Nominal)	Width (Min)			Lbs.	Kgs.
Black									
5510223	9/32	7	0.283	0.870	0.405	800	616	4,300	1,950
5510323	5/16	8	0.332	1.010	0.480	500	560	5,700	2,585
5510423	3/8	10	0.404	1.226	0.560	500	760	8,800	3,992
5510623	1/2	13	0.529	1.570	0.750	300	813	15,000	6,804
5510823	5/8	16	0.641	1.988	0.902	200	748	22,600	10,251
5510923	3/4	20	0.812	2.417	1.139	100	629	35,300	16,012
5511023	7/8	22	0.906	2.660	1.260	100	793	42,700	19,368
5511123	1	26	1.032	3.092	1.420	50	505	59,700	27,079

### G100 Alloy Chain - Half Drum

Stock #	Trade Size		Wire Dia. (inches)	Inside Link Dim. (In.)		Ft. Per Drum	Net Wt. (Lbs.)	WLL	
	Inches	MM		Length (Nominal)	Width (Min)			Lbs.	Kgs.
Black									
5510224	9/32	7	0.283	0.870	0.405	400	308	4,300	1,950
5510324	5/16	8	0.332	1.010	0.480	250	280	5,700	2,585
5510424	3/8	10	0.404	1.226	0.560	250	380	8,800	3,992
5510624	1/2	13	0.529	1.570	0.750	150	407	15,000	6,804

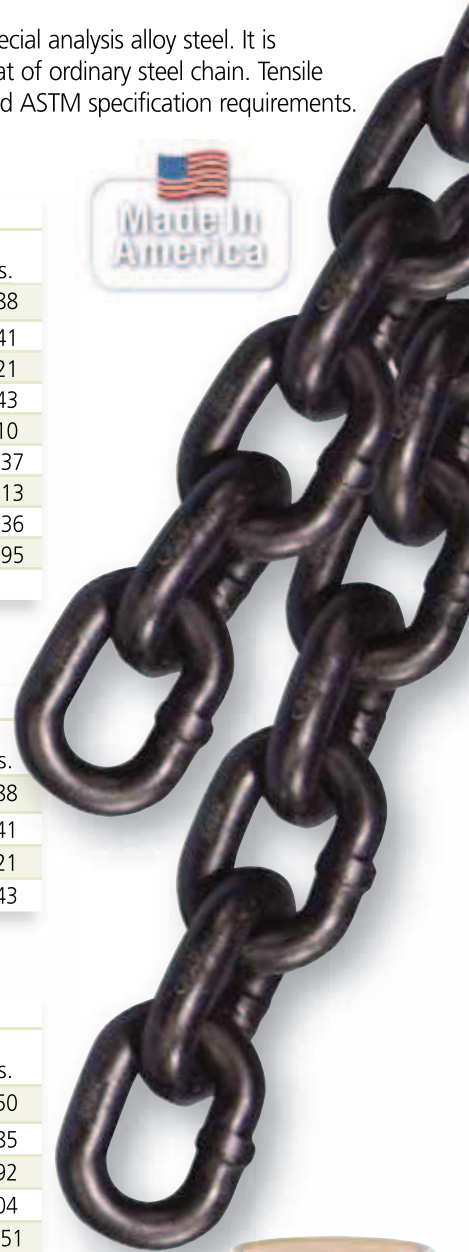

Do not exceed Working Load Limits (WLL)! See the SAFETY GUIDELINES section before using these products. Pages 150 - 155.

# OVERHEAD LIFTING

## Chain Sling Working Load Limit Specifications

Use this table as a guide to determine which chain sizes and leg styles are best for your requirements. Using the maximum load (or loads) you will lift, and the angle of lift required – work to the left across this table to determine proper chain size for your sling. Working load limit of the chain and components is established as pounds applied at the indicated degrees from horizontal. The rated capacity of the sling must be based on the smallest horizontal angle. For angles not shown, use the next lower angle or have a qualified person calculate the rated load for the new angle. When using hooks in a shortening (grab) or choker application, the Working Load Limit (WLL) of the sling must be reduced by 20%. The Grade 100 shortening Grab Hooks found on page 20 and 21 of this catalog require no reduction in WLL.

Chain Size		Single Leg Sling	Double Leg Sling			Triple & Quad Leg Sling		
Inches	MM		90°	60°	45°	30°	60°	45°
<b>Grade 80</b>								
7/32	6	2,100	3,600	3,000	2,100	5,500	4,400	3,200
9/32	7	3,500	6,100	4,900	3,500	9,100	7,400	5,200
5/16	8	4,500	7,800	6,400	4,500	11,700	9,500	6,800
3/8	10	7,100	12,300	10,000	7,100	18,400	15,100	10,600
1/2	13	12,000	20,800	17,000	12,000	31,200	25,500	18,000
5/8	16	18,100	31,300	25,600	18,100	47,000	38,400	27,100
3/4	20	28,300	49,000	40,000	28,300	73,500	60,000	42,400
7/8	22	34,200	59,200	48,400	34,200	88,900	72,500	51,300
1	26	47,700	82,600	67,400	47,700	123,900	101,200	71,500
1-1/4	32	72,300	125,200	102,200	72,300	187,800	153,400	108,400
1-1/2	38	100,000	173,200	141,400	100,000	259,800	212,100	150,000
1-3/4	45	131,250	227,300	185,600	131,250	341,000	278,400	196,900
2	50	175,000	303,100	247,500	175,000	454,600	371,200	262,500
<b>Grade 100</b>								
9/32	7	4,300	7,400	6,100	4,300	11,200	9,100	6,400
5/16	8	5,700	9,900	8,100	5,700	14,800	12,100	8,500
3/8	10	8,800	15,200	12,400	8,800	22,900	18,700	13,200
1/2	13	15,000	26,000	21,200	15,000	39,000	31,800	22,500
5/8	16	22,600	39,100	32,000	22,600	58,700	47,900	33,900
3/4	20	35,300	61,100	49,900	35,300	91,700	74,900	53,000
7/8	22	42,700	74,000	60,400	42,700	110,900	90,600	64,000
1	26	59,600	103,200	84,200	59,600	154,800	126,400	89,300

- DO NOT** load an assembly in excess of the rated working load limits in the chart above.
- DO NOT** put an unequal load on one leg of a sling. Distribute the load evenly.
- DO NOT** expose assembly to impact, rapid lifts or sudden stops.
- DO NOT** tie knots or allow chains to become twisted.
- DO NOT** use chain that appears to be defective, worn or damaged.
- DO NOT** fasten chain over sharp corners or edges. Protect with padding.
- DO NOT** tip load hooks. The latch must NEVER support the load.

When using non-cradle or non-shortening grab hooks in a shortening or choker application, the Working Load Limit (WLL) of the sling must be reduced by 20%

Reference the **SAFETY GUIDELINES** section of this catalog for more information.



Do not exceed Working Load Limits (WLL)! See the SAFETY GUIDELINES section before using these products. Pages 150 - 155.

# CHAIN SLING INFORMATION

## Welded Alloy Chain Slings

### Types of Chain Slings

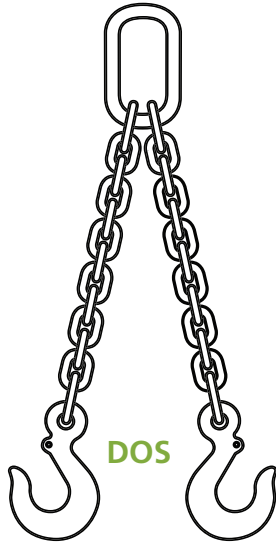

DOS

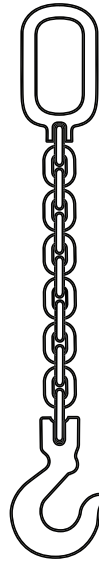

SOS

### Attachments

Type	One End	Opposite End
<b>Single Chain Slings</b>		
SOS	Oblong Link	Sling Hook
SOG	Oblong Link	Grab Hook
SGS	Grab Hook	Sling Hook
SGG	Grab Hook	Grab Hook
SSS	Sling Hook	Sling Hook
SOF	Oblong Link	Foundry Hook
SOO	Oblong Link	Oblong Link
<b>Double Chain Slings</b>		
DOS	Oblong Link	Sling Hooks
DOG	Oblong Link	Grab Hooks
DOF	Oblong Link	Foundry Hooks
<b>Triple Chain Slings</b>		
TOS	Oblong Link	Sling Hooks
TOG	Oblong Link	Grab Hooks
TOF	Oblong Link	Foundry Hooks
<b>Quadruple Chain Slings</b>		
QOS	Oblong Link	Sling Hooks
QOG	Oblong Link	Grab Hooks
QOF	Oblong Link	Foundry Hooks

### How to Order

The following information should be given on orders or inquiries for chain slings.

- 1. SIZE:** This is specified by the size of the material from which the chain is made, determined by working load limit required.
- 2. REACH:** This is the length, including attachments, measured from bearing point to bearing point.
- 3. TYPE:** Select and specify proper type of sling from list shown. Examples: S = single; O = oblong link; S = sling hook
- 4. ATTACHMENTS:** Unless otherwise specified standard master links as given herein will be used. When other than standard master links or hooks are required, we should be given a complete description or a drawing of the requested substitute.

When hot galvanizing is specified our recommended working load limits must be reduced. Please contact us with all such inquiries.



SOO

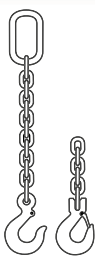

SOS or SOSH



SOG



SOF



DOS

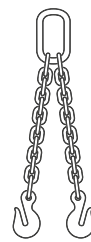

DOG

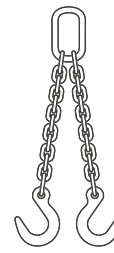

DOF

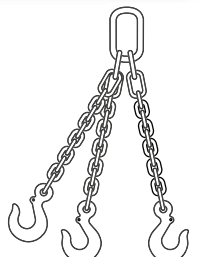

TOS

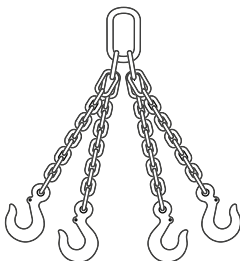

QOS



Adjustable Single

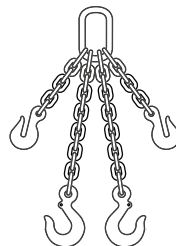

Adjustable Double



Single Endless Basket



Double Endless Basket



Do not exceed Working Load Limits (WLL)!  
See the SAFETY GUIDELINES section before using these products. Pages 150 - 155.

# OVERHEAD LIFTING

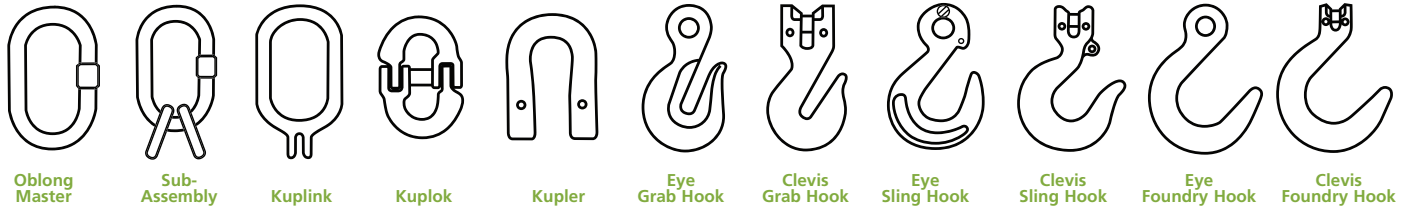

## Accoloy® Kuplex® Component Reference

### Single Leg Chain Slings

Chain Size	Oblong Master	Kuplink®	Kupler®	Eye Grab Hook	Clevis Grab Hook	Eye Sling Hook	Clevis Sling Hook	Eye Foundry Hook	Clevis Foundry Hook
9/32	598350001††	598350011††	---	592252072††	598750072††	592353080††	598850080††	592454498††	598250498††
3/8	598350002††	598350012††	---	592252073††	598750073††	592353081††	598850081††	592454499††	598250499††
1/2	598350003††	598350013††	---	592252075††	598750075††	592353082††	598850082††	592454500††	598250500††
5/8	598350003††	598350014††	---	592252076††	598750076††	592353083††	598850083††	592454501††	598250501††
3/4	598350004††	598300015†	---	592202077†	598700077†	592303084†	598800084†	592404502†	598200502†
7/8	598350005	---	598100025†	592202078†	598700078†	592303085†	598800085†	592404503†	598200503†
1	598310006	---	599100026	592202079†	---	592303086†	598800086	592404504†	---
1-1/4	598300030	---	599100028	592202051†	---	592303088†	---	592404505†	---

### Double Leg Chain Slings

Chain Size	Oblong Master	Kuplink®	Kupler®	Eye Grab Hook	Clevis Grab Hook	Eye Sling Hook	Clevis Sling Hook	Eye Foundry Hook	Clevis Foundry Hook
9/32	598350001††	594200400†	598150020†	592252072††	598750072††	592353080††	598850080††	592454498††	598250498††
3/8	598350002††	594200601††	598150021†	592252073††	598750073††	592353081††	598850081††	592454499††	598250499††
1/2	598350003††	594200801†	598150022†	592252075††	598750075††	592353082††	598850082††	592454500††	598250500††
5/8	598350004††	594201001†	598150023†	592252076††	598750076††	592353083††	598850083††	592454501††	598250501††
3/4	598350005	594201201†	598100024†	592202077†	598700077†	592303084†	598800084†	592404502†	598200502†
7/8	598310006	---	598100025†	592202078†	598700078†	592303085†	598800085†	592404503†	598200503†
1	598300030	---	599100026	592202079†	---	592303086†	598800086	592404504†	---
1-1/4	598300034	---	599100028	592202051†	---	592303088†	---	592404505†	---

### Triple & Quad Leg Chain Slings

Chain Size	Sub Assemblies	Kuplok®	Kupler®	Eye Grab Hook	Clevis Grab Hook	Eye Sling Hook	Clevis Sling Hook	Eye Foundry Hook	Clevis Foundry Hook
9/32	599450401	594200400†	598150020†	592252072††	598750072††	592353080††	598850080††	592454498††	598250498††
3/8	599450601	594200601†	598150021†	592252073††	598750073††	592353081††	598850081††	592454499††	598250499††
1/2	599450801	594200801†	598150022†	592252075††	598750075††	592353082††	598850082††	592454500††	598250500††
5/8	599451001	594201001†	598150023†	592252076††	598750076††	592353083††	598850083††	592454501††	598250501††
3/4	599401201	594201201†	598100024†	592202077†	598700077†	592303084†	598800084†	592404502†	598200502†
7/8	599401401	---	598100025†	592202078†	598700078†	592303085†	598800085†	592404503†	598200503†
1	599401601	---	599100026	592202079†	---	592303086†	598800086	592404504†	---
1-1/4	599402001	---	599100028	592202051†	---	592303088†	---	592404505†	---

Values not specially marked are Grade 63.

† Values shown for these sizes are Grade 80.

†† Values shown for these sizes are Grade 100.



Single Sling



Double Sling



Triple Sling

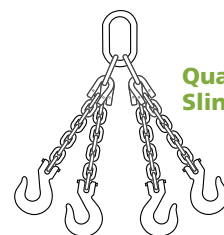

Quadruple Sling



**WARNING** Do not exceed Working Load Limits (WLL)! See the SAFETY GUIDELINES section before using these products. Pages 150 - 155.

# ACCOLOY® KUPLEX® ALLOY CHAIN ACCESSORIES



## Accoloy® Kuplex®

### Oblong Master Links

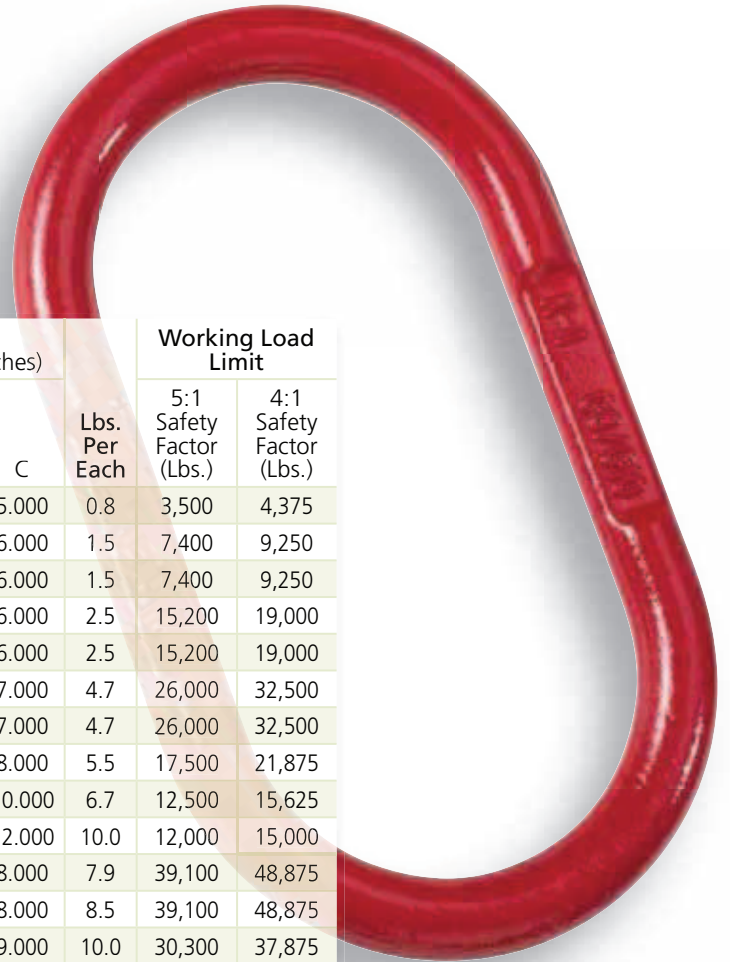

Stock #	ID #	Type	Finish	Grade	Dimensions (inches)			Lbs. Per Each	Working Load Limit	
					A	B	C		5:1 Safety Factor (Lbs.)	4:1 Safety Factor (Lbs.)
598300046		Welded	Painted	80	0.500	2.500	5.000	0.8	3,500	4,375
598300047		Forged	Unpainted	100	0.625	3.000	6.000	1.5	7,400	9,250
598350001	K-1	Forged	Painted	100	0.625	3.000	6.000	1.5	7,400	9,250
598300048		Forged	Unpainted	100	0.750	3.000	6.000	2.5	15,200	19,000
598350002	K-2	Forged	Painted	100	0.750	3.000	6.000	2.5	15,200	19,000
598350003	K-3	Forged	Painted	100	1.000	3.500	7.000	4.7	26,000	32,500
598300049		Forged	Unpainted	100	1.000	3.500	7.000	4.7	26,000	32,500
598300058		Forged	Unpainted	80	1.000	4.000	8.000	5.5	17,500	21,875
598300050		Welded	Unpainted	80	1.000	6.000	10.000	6.7	12,500	15,625
598300051		Welded	Unpainted	80	1.000	6.000	12.000	10.0	12,000	15,000
598300052		Forged	Unpainted	100	1.250	4.000	8.000	7.9	39,100	48,875
598350004	K-4	Forged	Painted	100	1.250	4.000	8.000	8.5	39,100	48,875
598300017		Welded	Unpainted	80	1.250	4.500	9.000	10.0	30,300	37,875
598300019		Welded	Unpainted	80	1.250	8.000	12.000	14.0	19,800	24,750
598300020		Welded	Unpainted	80	1.375	6.000	10.000	14.0	31,900	39,875
598300022		Welded	Unpainted	100	1.500	6.000	12.000	18.0	58,700	73,375
598350005	K-5	Welded	Painted	100	1.500	6.000	12.000	17.5	58,700	73,375
598300023		Welded	Unpainted	80	1.500	8.000	16.000	23.0	30,200	37,750
598300025		Welded	Unpainted	80	1.750	6.000	12.000	24.8	73,500	91,875
598310006	K-6	Welded	Painted	80	1.750	6.000	12.000	24.8	73,500	91,875
598300026		Welded	Unpainted	80	1.750	8.000	16.000	34.0	47,400	59,250
598300028		Welded	Unpainted	80	1.750	10.000	21.000	40.2	38,000	47,500
598300030		Welded	Unpainted	80	2.000	7.000	14.000	38.0	88,900	111,125
598300034		Welded	Unpainted	80	2.250	8.000	16.000	58.0	125,200	156,500
598300038		Welded	Unpainted	80	2.500	8.000	16.000	73.8	135,000	168,750
598300039		Welded	Unpainted	80	2.750	8.000	16.000	87.5	178,400	223,000
598300036		Welded	Unpainted	80	2.750	9.000	16.000	92.0	164,400	205,500
598300040		Welded	Unpainted	80	3.000	9.000	18.000	112.0	178,900	223,625
598300041		Welded	Unpainted	80	3.250	10.000	20.000	170.0	205,200	256,500
598300042		Welded	Unpainted	80	3.500	10.000	20.000	210.0	254,500	318,125
598300043		Welded	Unpainted	80	4.000	10.000	20.000	242.0	375,000	468,750
598300044		Welded	Unpainted	80	4.500	12.000	24.000	395.0	447,000	558,750
598300045		Welded	Unpainted	80	5.000	12.000	24.000	475.0	607,000	758,750

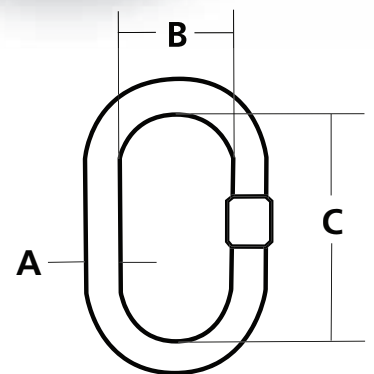

Do not exceed Working Load Limits (WLL)!  
See the SAFETY GUIDELINES section before using these products. Pages 150 - 155.

# OVERHEAD LIFTING

## Kuplex® Master Kuplinks

Master Kuplinks® are the optimum of chain to master link connections. In addition to the streamline characteristics of the Kuplink®, there is a definite advantage to field assembly since other coupling devices are unnecessary.

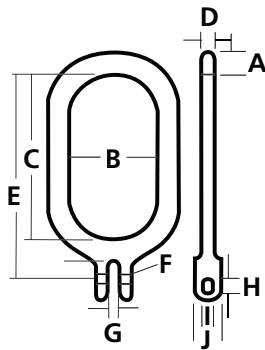

Stock #	Red	ID #	Chain Size			Dimensions (Inches)										Lbs. Per Each	WLL (Lbs.)
			In.	MM	Grade	A	B	C	D	E	F	G	H	I	J		
598350011		K-11	9/32	7	100	0.750	3.000	6.000	0.500	7.125	0.125	0.313	0.406	0.344	0.625	2.5	4,300
598350012		K-12	3/8	10	100	0.750	3.000	6.000	0.500	7.250	0.156	0.438	0.563	0.469	0.875	2.7	8,800
598350013		K-13	1/2	13	100	0.938	3.000	6.000	0.688	7.563	0.188	0.563	0.750	0.656	1.125	4.4	15,000
598350014		K-14	5/8	16	100	1.125	4.000	8.000	0.875	9.938	0.250	0.688	0.938	0.813	1.500	8.2	22,600
598300015		K-15	3/4	20	80	1.250	4.000	8.000	0.875	10.188	0.313	0.813	1.219	1.000	1.750	11.6	28,300

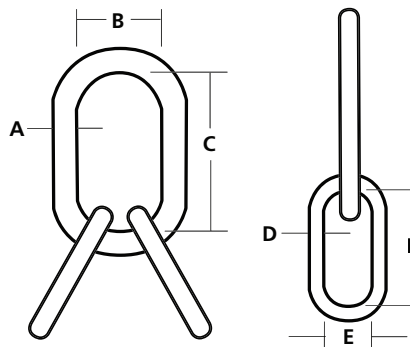

## Accoloy® Kuplex® Sub-Assemblies

These Oblong Sub-Assemblies are fabricated from premium fine grain alloy steel subjected to high quality heat treatment and quality control associated with other Peerless products.

Stock #	Chain Size			Dimensions (Inches)						Lbs. Per Each	Working Load Limit (Lbs.)		
	Inches	MM	Grade	A	B	C	D	E	F		@ 60°	@ 45°	@ 30°
599450401	9/32	7	100	0.750	3.000	6.000	0.625	1.156	2.188	3.8	11,200	9,100	6,400
599450601	3/8	10	100	1.000	3.500	7.000	0.750	1.500	3.000	7.2	22,900	18,700	13,200
599450801	1/2	13	100	1.250	4.000	8.000	1.031	2.000	4.000	15.0	39,000	31,800	22,500
599451001	5/8	16	100	1.500	6.000	12.000	1.125	2.250	4.563	26.2	58,700	47,900	33,900
599401201	3/4	20	80	1.750	6.000	12.000	1.500	2.500	5.250	42.3	73,500	60,000	42,400
599401401	7/8	22	80	2.000	7.000	14.000	1.750	3.000	6.000	65.5	88,900	72,500	51,300
599401601	1	26	80	2.250	8.000	16.000	1.875	5.000	10.000	102.6	123,900	101,200	71,500
599402001	1-1/4	32	80	2.750	9.000	16.000	2.250	5.000	10.000	160.0	187,800	153,400	108,400



# ACCOLOY® KUPLEX® ALLOY CHAIN ACCESSORIES



## Kuplex® Kuplok®

Kuplok mechanical coupling links, an essential component of mechanically coupled slings, are used to assemble chain legs to the master link and/or attach eye type fittings.

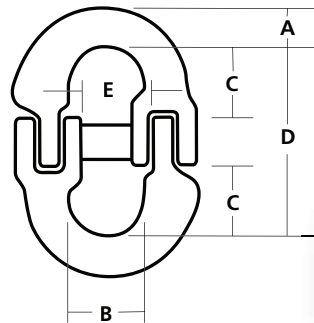

Stock #	Chain Size			Dimensions (Inches)					Lbs. Per Each	WLL (Lbs.)	
	Red	Inches	MM	Grade	A	B	C	D			E
594200400		9/32	7	80	0.375	0.688	0.625	1.813	0.500	0.3	3,500
594200601		3/8	10	80	0.500	1.000	0.938	2.375	0.750	0.6	7,100
594200801		1/2	13	80	0.625	1.250	1.375	2.344	1.000	1.5	12,000
594201001		5/8	16	80	0.750	1.500	1.688	4.000	1.250	2.4	18,100
594201201		3/4	20	80	0.938	1.750	2.000	4.750	1.625	3.6	28,300

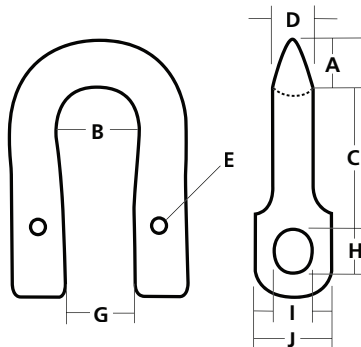

## Kuplex® Kuplers®

Kuplers act as a connection device between Master Links and Chain on all multiple leg Kuplex II Chain Slings. On single leg assemblies, they can be used in lieu of the popular Kuplex II Kuplink. Resembling a shackle in appearance, the Kuplers provide a high strength, high integrity connection, when used to connect a special attachment to the alloy chain assembly.

Stock #	Red	ID #	Chain Size		Dimensions (Inches)									Lbs. Per Each	WLL (Lbs.)	
			Inches	MM	Grade	A	B	C	D	E	G	H	I			J
598150020		K-20	9/32	7	80	0.438	0.813	1.313	0.313	0.125	0.719	0.406	0.344	0.625	0.3	3,500
598150021		K-21	3/8	10	80	0.594	1.063	1.813	0.438	0.156	0.875	0.563	0.469	0.875	0.7	7,100
598150022		K-22	1/2	13	80	0.750	1.313	2.563	0.563	0.188	1.094	0.750	0.656	1.125	1.5	12,000
598150023		K-23	5/8	16	80	0.938	1.625	3.000	0.688	0.250	1.344	0.938	0.813	1.500	3.0	18,100
598100024		K-24	3/4	20	80	1.000	1.938	3.406	0.813	0.313	1.594	1.219	1.000	1.750	4.8	28,300
598100025		K-25	7/8	22	80	1.125	2.250	3.875	0.938	0.375	1.844	1.281	1.063	2.000	6.1	34,200
599100026		K-26	1	26	63	1.250	2.688	4.250	1.063	---	2.000	1.219	1.094	2.375	8.4	35,900
599100028		K-28	1-1/4	32	63	1.500	3.500	5.125	1.313	---	2.281	1.500	1.344	2.875	14.8	56,100



Do not exceed Working Load Limits (WLL)!  
See the SAFETY GUIDELINES section before using these products. Pages 150 - 155.



# OVERHEAD LIFTING



## Sling Hooks

### Accoloy® Eye Sling Hooks

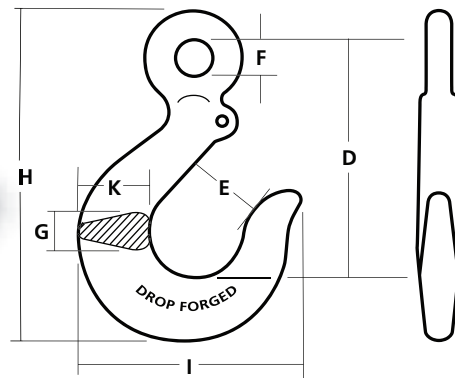

Stock #	Chain Size			Dimensions (Inches)							Lbs. Per Each	WLL (Lbs.)	
	Red	Inches	MM	Grade	D	E	F	G	H	I			K
592353080		9/32	7	100	3.813	1.219	0.625	0.688	5.219	3.625	1.063	1.0	4,300
592353081		3/8	10	100	5.375	1.625	0.813	0.938	7.250	4.813	1.375	2.5	8,800
592353082		1/2	13	100	6.563	2.000	1.031	1.188	8.938	6.063	1.813	5.3	15,000
592353083		5/8	16	100	7.750	2.438	1.250	1.313	10.375	7.156	2.125	7.9	22,600
592303084		3/4	20	80	8.875	2.688	1.500	1.500	11.938	7.875	2.313	11.2	28,300
592303085		7/8	22	80	10.125	3.000	1.750	1.750	13.750	9.156	2.750	19.6	34,200
*592303086		1	26	80	11.063	3.375	2.000	1.875	15.000	10.063	3.000	21.8	47,700
*592303088		1-1/4	32	80	13.125	4.063	2.250	2.313	18.000	12.313	3.750	44.4	72,300

\* Latch eye hole drilled only by request.

### Kuplex® Clevis Sling Hooks

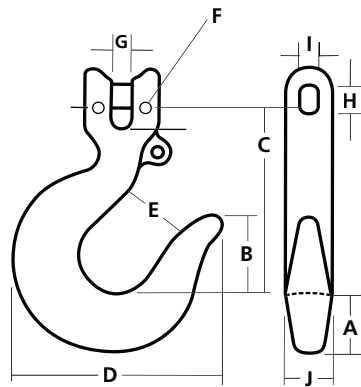

Stock #	Red	ID #	Chain Size			Dimensions (Inches)									Lbs. Per Each	WLL (Lbs.)	
			Inches	MM	Grade	A	B	C	D	E	F	G	H	I			J
598850080		K-80	9/32	7	100	1.000	1.500	3.313	3.625	1.125	0.125	0.313	0.406	0.344	0.625	1.3	4,300
598850081		K-81	3/8	10	100	1.281	2.031	4.781	4.813	1.625	0.156	0.438	0.563	0.469	0.875	3.1	8,800
598850082		K-82	1/2	13	100	1.688	2.438	6.125	6.125	2.000	0.188	0.563	0.750	0.656	1.125	6.5	15,000
598850083		K-83	5/8	16	100	1.938	2.875	6.813	7.219	2.438	0.250	0.688	0.938	0.813	1.500	10.7	22,600
598800084		K-84	3/4	20	80	2.375	3.250	8.531	8.188	2.688	0.313	0.813	1.219	1.000	1.750	16.6	28,300
598800085		K-85	7/8	22	80	2.750	3.656	9.625	9.469	3.000	0.375	0.938	1.281	1.063	2.000	25.9	34,200
599800086		K-86	1	26	63	2.688	4.063	10.063	10.063	3.375	---	1.375	1.219	1.094	1.875	26.9	35,900



Do not exceed Working Load Limits (WLL)! See the SAFETY GUIDELINES section before using these products. Pages 150 - 155.

# ACCOLOY® KUPLEX® ALLOY CHAIN ACCESSORIES



## Grab Hooks

### Accoloy® Eye Grab Hooks

Stock #	Chain Size			Dimensions (Inches)						Lbs. Per Each	WLL (Lbs.)	
	Red	Inches	MM	Grade	D	E	F	G	H			I
592252072		9/32	7	100	2.688	0.344	0.625	0.609	4.125	2.375	0.7	4,300
592252073		3/8	10	100	3.375	0.484	0.813	0.734	5.031	2.844	1.2	8,800
592252075		1/2	13	100	4.250	0.641	1.031	0.969	6.469	3.719	2.6	15,000
592252076		5/8	16	100	5.281	0.781	1.250	1.188	8.000	4.563	4.9	22,600
592202077		3/4	20	80	6.250	0.938	1.500	1.406	9.469	5.469	8.2	28,300
592202078		7/8	22	80	7.250	1.094	1.750	1.625	11.000	6.375	12.1	34,200
592202079		1	26	80	8.000	1.188	1.875	1.813	12.156	6.750	19.9	47,700
592202051		1-1/4	32	80	10.500	1.500	2.250	2.500	15.563	8.250	40.0	72,300

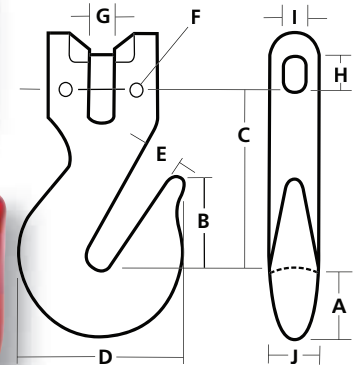
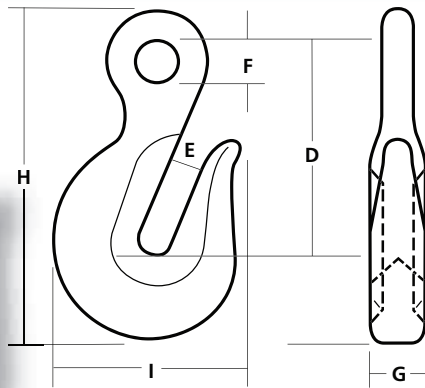

### Kuplex® Clevis Type Grab Hooks

Stock #	Red	ID #	Chain Size			Dimensions (Inches)										Lbs. Per Each	WLL (Lbs.)
			Inches	MM	Grade	A	B	C	D	E	F	G	H	I	J		
598750072		K-72	9/32	7	100	0.688	1.250	2.125	2.125	0.375	0.125	0.313	0.406	0.344	0.625	0.6	4,300
598750073		K-73	3/8	10	100	1.031	1.500	2.875	2.625	0.500	0.156	0.438	0.563	0.469	0.875	1.5	8,800
598750075		K-75	1/2	13	100	1.250	2.000	3.563	3.344	0.625	0.188	0.563	0.750	0.656	1.125	3.4	15,000
598750076		K-76	5/8	16	100	1.625	2.375	4.313	4.250	0.781	0.250	0.688	0.938	0.813	1.500	6.2	22,600
598700077		K-77	3/4	20	80	1.875	2.938	5.094	5.063	0.875	0.313	0.813	1.219	1.000	1.750	10.1	28,300
598700078		K-78	7/8	22	80	2.125	3.500	5.875	6.094	1.125	0.375	0.938	1.281	1.063	2.000	14.8	34,200



Do not exceed Working Load Limits (WLL)! See the SAFETY GUIDELINES section before using these products. Pages 150 - 155.

# OVERHEAD LIFTING



## Foundry Hooks

### Accoloy® Eye Foundry Hooks

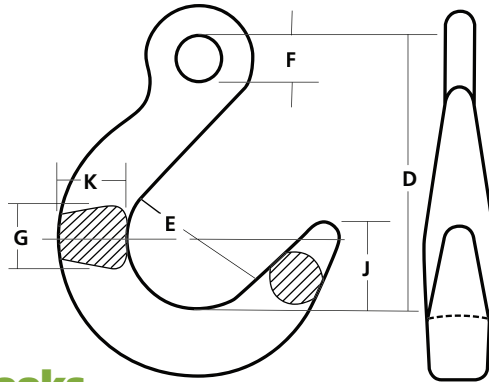

Stock #	Chain Size			Dimensions (Inches)						Lbs. Per Each	WLL (Lbs.)	
	Red	Inches	MM	Grade	D	E	F	G	J			K
592454498	Red	9/32	7	100	4.750	2.625	0.625	1.000	1.563	1.125	2.0	4,300
592454499	Red	3/8	10	100	5.750	3.125	0.813	1.250	1.875	1.375	4.1	8,800
592454500	Red	1/2	13	100	6.875	3.750	1.031	1.500	2.250	1.625	7.0	15,000
592454501	Red	5/8	16	100	8.063	4.250	1.250	1.750	2.625	1.875	10.5	22,600
592404502	Red	3/4	20	80	9.250	4.750	1.500	2.000	3.000	2.125	18.2	28,300
592404503	Red	7/8	22	80	10.375	5.250	1.750	2.250	3.375	2.375	26.0	34,200
592404504	Red	1	26	80	11.563	5.750	2.000	2.500	2.750	2.750	35.0	47,700
592404505	Red	1-1/4	32	80	12.750	6.375	2.250	3.000	4.250	3.250	50.0	72,300

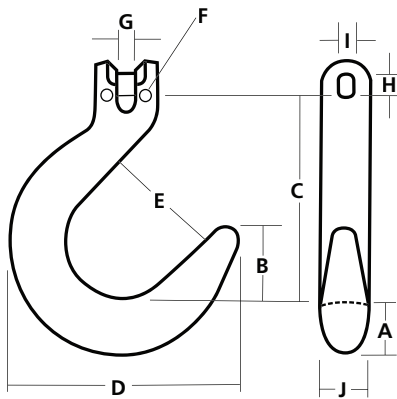

### Kuplex® Clevis Foundry Hooks

Stock #	Red	ID #	Chain Size			Dimensions (Inches)										Lbs. Per Each	WLL (Lbs.)
			Inches	MM	Grade	A	B	C	D	E	F	G	H	I	J		
598250498	Red	K-498	9/32	7	100	1.125	1.563	4.438	4.875	2.625	0.125	0.313	0.406	0.344	0.875	2.1	4,300
598250499	Red	K-499	3/8	10	100	1.375	1.875	5.500	5.875	3.000	0.156	0.438	0.563	0.469	1.125	4.3	8,800
598250500	Red	K-500	1/2	13	100	1.500	2.250	6.625	6.875	3.875	0.188	0.563	0.750	0.656	1.500	8.2	15,000
598250501	Red	K-501	5/8	16	100	2.188	2.563	7.625	8.281	4.125	0.250	0.688	0.938	0.813	1.750	14.4	22,600
598200502	Red	K-502	3/4	20	80	2.750	3.000	8.813	9.625	4.813	0.313	0.813	1.219	1.000	2.000	24.5	28,300
598200503	Red	K-503	7/8	22	80	3.000	3.375	9.938	10.688	5.375	0.375	0.938	1.281	1.063	2.250	33.1	34,200



# ACCOLOY® KUPLEX® ALLOY CHAIN ACCESSORIES

## Kuplex® Load Pins & Retaining Pins

All Kuplex components derive their integrity connection from the special Kuplex Load Pins and Spiral Pins. The load pins are made from alloy steel heat treated to obtain optimum rated performance properties. The load pins are specially shaped to develop strength characteristics and resistance to bending under rated load. The oval shape presents a greater force area than conventional round pins.

Chain Size (Inches)	Hooks & Kuplinks				Kuplers		Retaining Pin	
	Stock # Load Pin Set*	H (Inches)	I (Inches)	K (Inches)	Stock # Load Pin Set	K (Inches)	Stock #	Qty Per Ctn.
9/32	598950232	0.406	0.313	1.156	598950132	1.531	598900332	100
3/8	598950233	0.563	0.469	1.656	598950133	2.094	598900333	50
1/2	598950234	0.719	0.625	2.219	598950134	2.719	598900334	50
5/8	598950235	0.922	0.781	2.563	598950135	3.219	598900335	25
3/4	598900236	1.188	1.000	3.125	598900136	3.938	598900336	10
7/8	598900237	1.250	1.063	3.563	598900137	4.531	---	Bulk



**Important:** Use only genuine Kuplex load and retaining pins when assembling slings. Never use rods, bolts or other objects of questionable strength and metallurgy. Failure could cause serious injury or damage to property.

\* One Load Pin and two Spiral Pins are bagged. There is an occasional need for replacement of Spiral Pins and Load Pins. The same Load Pins cannot be used in both Kuplers and Hooks. When ordering these parts separately, be sure to specify whether they are for Kuplers or Hooks and also specify Kupler Number or the Hook Number with which they are to be used.

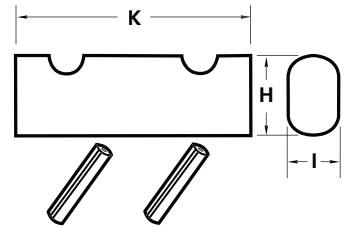

## Accoloy® Kuplex® Latch Assembly

For use w/both Accoloy Eye Type & Kuplex Clevis Type Sling Hooks. One per bag.

Chain Size (Inches)	Stock #	For Hook:		E (Inches)
		Accoloy Eye Sling Hook	Kuplex Clevis Sling Hook	
9/32	599900402	592353080	598850080	1.000
3/8	599900403	592353081	598850081	1.375
1/2	599900404	592353082	598850082	1.625
5/8	599900405	592353083	598850083	2.125
3/4	599900406	592303084	598800084	2.438
7/8	599900407	592303085	598800085	2.625
1	599900408	592303086	599800086	3.250
1-1/4	599900410	592303088	---	3.750

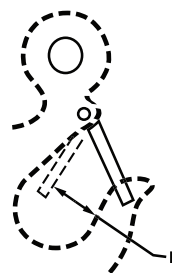

## Kuplex® Kuplok® Replacement Pins & Bushings

Chain Size (Inches)	Stock#	
	Pin	Bushing
9/32	594300403	594300404
3/8	594300603	594300604
1/2	594300803	594300804
5/8	594301003	594301004
3/4	594301203	594301204



Do not exceed Working Load Limits (WLL)! See the SAFETY GUIDELINES section before using these products. Pages 150 - 155.

# OVERHEAD LIFTING

## V10™ Component Reference

### Single Leg Chain Slings

Chain Size		Oblong Master	Coupling Link	Eye Grab Hook	Clevis Grab Hook	Clevis Grab w/ Safety Pin	Eye Grab w/ Clevis Attachment	Eye Sling Hook	Clevis Sling Hook	Eye Foundry Hook	Eye Self-Locking Hook	Clevis Self-Locking Hook	Swivel Self-Locking Hook	Swivel Self-Locking Hook w/ Bearing
In.	MM													
7/32	6	8451000	8452900	8427100	8428100	8429100	8420100	8417100	8418100	---	8497100	8498100	8499100	8491100
9/32	7	8451000	8453100	8427200	8428200	8429200	8420200	8417200	8418200	8477200	8497200	8498200	8499200	8491200
5/16	8	8451100	8453000	8427200	8428200	8429200	8420200	8417200	8418200	8477200	8497200	8498200	8499200	8491200
3/8	10	8451200	8453210	8427400	8428400	8429400	8420400	8417400	8418400	8477400	8497400	8498400	8499400	8491400
1/2	13	8451300	8453300	8427600	8428610	8429620	8420600	8417600	8418600	8477600	8497600	8498600	8499600	8491600
5/8	16	8451400	8453400	8427700	8428710	8429720	8420700	8417700	8418700	8477700	8497700	8498800	8499700	8491700
3/4	20	8451500	8453510	8427800	8428810	---	---	8417800	8418800	8477800	---	---	---	---
7/8	22	8451600	8453610	8427900	8428910	---	---	8417900	8418900	---	---	---	---	---

### Double Leg Chain Slings

Chain Size		Oblong Master	Coupling Link	Eye Grab Hook	Clevis Grab Hook	Clevis Grab w/ Safety Pin	Eye Grab w/ Clevis Attachment	Eye Sling Hook	Clevis Sling Hook	Eye Foundry Hook	Eye Self-Locking Hook	Clevis Self-Locking Hook	Swivel Self-Locking Hook	Swivel Self-Locking Hook w/ Bearing
In.	MM													
7/32	6	8451000	8452900	8427100	8428100	8429100	8420100	8417100	8418100	---	8497100	8498100	8499100	8491100
9/32	7	8451100	8453100	8427200	8428200	8429200	8420200	8417200	8418200	8477200	8497200	8498200	8499200	8491200
5/16	8	8451200	8453000	8427200	8428200	8429200	8420200	8417200	8418200	8477200	8497200	8498200	8499200	8491200
3/8	10	8451300	8453210	8427400	8428400	8429400	8420400	8417400	8418400	8477400	8497400	8498400	8499400	8491400
1/2	13	8451400	8453300	8427600	8428610	8429620	8420600	8417600	8418600	8477600	8497600	8498600	8499600	8491600
5/8	16	8451500	8453400	8427700	8428710	8429720	8420700	8417700	8418700	8477700	8497700	8498800	8499700	8491700
3/4	20	8451600	8453510	8427800	8428810	---	---	8417800	8418800	8477800	---	---	---	---
7/8	22	8451700	8453610	8427900	8428910	---	---	8417900	8418900	---	---	---	---	---

### Triple & Quad Leg Chain Slings

Chain Size		Sub Assemblies		Coupling Link	Eye Grab Hook	Clevis Grab Hook	Clevis Grab w/ Safety Pin	Eye Grab w/ Clevis Attachment	Eye Sling Hook	Clevis Sling Hook	Eye Foundry Hook	Eye Self-Locking Hook	Clevis Self-Locking Hook	Swivel Self-Locking Hook	Swivel Self-Locking Hook w/ Bearing
In.	MM	Sm. Sub-Links	Lg. Sub-Links												
7/32	6	8452110	8452100	8452900	8427100	8428100	8429100	8420100	8417100	8418100	---	8497100	8498100	8499100	8491100
9/32	7	8452110	8452100	8453100	8427200	8428200	8429200	8420200	8417200	8418200	8477200	8497200	8498200	8499200	8491200
5/16	8	8452210	8452200	8453000	8427200	8428200	8429200	8420200	8417200	8418200	8477200	8497200	8498200	8499200	8491200
3/8	10	8452310	8452300	8453210	8427400	8428400	8429400	8420400	8417400	8418400	8477400	8497400	8498400	8499400	8491400
1/2	13	8452410	8452400	8453300	8427600	8428610	8429620	8420600	8417600	8418600	8477600	8497600	8498600	8499600	8491600
5/8	16	8452510	8452500	8453400	8427700	8428710	8429720	8420700	8417700	8418700	8477700	8497700	8498800	8499700	8491700
3/4	20	8452610	8452600	8453510	8427800	8428810	---	---	8417800	8418800	8477800	---	---	---	---
7/8	22	8452710	8452700	8453610	8427900	8428910	---	---	8417900	8418900	---	---	---	---	---



# V10™ ALLOY CHAIN ACCESSORIES



## Oblong Master Links

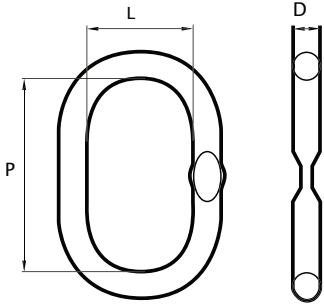

Stock #	Mfr. #	Trade Size		Dimensions (Inches)			Lbs. Per Each	Working Load Limit	
		Inches	MM	D	P	L		5:1 Safety Factor (lbs.)	4:1 Safety Factor (lbs.)
8451000	D13	1/2	13	0.512	4.331	2.362	0.8	4,240	5,300
8451100	D16	5/8	16	0.630	4.331	2.362	1.2	5,920	7,400
8451200	D18	3/4	18	0.748	5.315	2.953	2.0	8,960	11,200
8451300	D22	7/8	22	0.906	6.299	3.543	3.5	12,160	15,200
8451400	D26	1	26	1.063	7.087	3.937	5.5	21,120	26,400
8451500	D32	1-1/4	32	1.299	7.874	4.331	9.3	31,760	39,700
8451600	D38	1-1/2	38	1.496	10.827	5.906	16.5	48,880	61,100
8451700	D45	1-3/4	45	1.772	13.386	7.087	28.3	63,440	79,300
8451800	D50	2	50	1.969	13.780	7.480	36.4	82,880	103,600
8451900	D60	2-1/4	60	2.362	15.748	7.874	59.5	105,760	132,200

## Oblong Master Links \*4:1 Safety Factor for Grade 80 Chain Slings

Stock #	Blue	Mfr. #	Single Leg			Double Leg				
			Chain Size		*WLL @ 90° (Lbs.)	Chain Size		*WLL @ 60° (Lbs.)	*WLL @ 45° (Lbs.)	*WLL @ 30° (Lbs.)
			Inches	MM		Inches	MM			
8451000	D13	9/32	7	3,500	7/32	6	3,600	3,000	2,100	
8451100	D16	5/16	8	4,500	9/32	7	6,100	4,900	3,500	
8451200	D18	3/8	10	7,100	5/16	8	7,800	6,400	4,500	
8451300	D22	1/2	13	12,000	3/8	10	12,300	10,000	7,100	
8451400	D26	5/8	16	18,100	1/2	13	20,800	17,000	12,000	
8451500	D32	3/4	20	28,300	5/8	16	31,300	25,600	18,100	
8451600	D38	7/8	22	34,200	3/4	20	49,000	40,000	28,300	
8451700	D45	1	26	47,700	7/8	22	59,200	48,400	34,200	
8451800	D50	1-1/4	32	72,300	1	26	82,600	67,400	47,700	
8451900	D60	1-1/2	38	—	1-1/4	32	125,200	102,200	72,300	

## Oblong Master Links \*4:1 Safety Factor for Grade 100 Chain Slings

Stock #	Blue	Mfr. #	Single Leg			Double Leg				
			Chain Size		*WLL @ 90° (Lbs.)	Chain Size		*WLL @ 60° (Lbs.)	*WLL @ 45° (Lbs.)	*WLL @ 30° (Lbs.)
			Inches	MM		Inches	MM			
8451000	D13	9/32	7	4,300	7/32	6	4,700	3,800	2,700	
8451100	D16	5/16	8	5,700	9/32	7	7,400	6,100	4,300	
8451200	D18	3/8	10	8,800	5/16	8	9,900	8,100	5,700	
8451300	D22	1/2	13	15,000	3/8	10	15,200	12,400	8,800	
8451400	D26	5/8	16	22,600	1/2	13	26,000	21,200	15,000	
8451500	D32	3/4	20	35,300	5/8	16	39,100	32,000	22,600	
8451600	D38	7/8	22	42,700	3/4	20	61,100	49,900	35,300	
8451700	D45	1	26	59,700	7/8	22	74,000	60,400	42,700	
8451800	D50	1-1/4	32	90,400	1	26	103,400	84,400	59,700	
8451900	D60	1-1/2	38	—	1-1/4	32	156,600	127,800	90,400	



Do not exceed Working Load Limits (WLL)! See the SAFETY GUIDELINES section before using these products. Pages 150 - 155.

# OVERHEAD LIFTING

## Sub-Assemblies w/Small Sub-Links

Stock #	Mfr. #	Trade Size		Dimensions (Inches)						Lbs. Per Each	Working Load Limit	
		Inches	MM	D	P	L	D1	P1	L1		5:1 Safety Factor (lbs.)	4:1 Safety Factor (lbs.)
8452110	D18L13	3/4	19	0.748	5.315	2.953	0.512	2.362	1.496	3.0	8,960	11,200
8452210	D22L16	7/8	22	0.906	6.299	3.543	0.630	2.756	1.339	5.3	12,160	15,200
8452310	D26L20	1	26	1.063	7.087	3.937	0.748	3.346	1.575	8.4	18,320	22,900
8452410	D32L22	1-1/4	32	1.299	7.874	4.331	0.906	4.528	1.969	14.5	31,760	39,700
8452510	D38L26	1-1/2	38	1.496	10.827	5.906	1.063	5.512	2.559	25.3	48,880	61,100
8452610	D50L32	2	50	1.969	13.780	7.480	1.299	5.906	2.756	50.7	73,360	91,700
8452710	D56L36	2-1/4	56	2.205	13.780	9.843	1.417	6.693	2.953	68.4	88,720	110,900

## Sub-Assemblies w/Small Sub-Links \*4:1 Safety Factor for Chain Slings

Stock #	Blue	Mfr. #	Chain Size		G80 Triple & Quad Leg			G100 Triple & Quad Leg		
			Inches	MM	*WLL @ 60° (Lbs.)	*WLL @ 45° (Lbs.)	*WLL @ 30° (Lbs.)	*WLL @ 60° (Lbs.)	*WLL @ 45° (Lbs.)	*WLL @ 30° (Lbs.)
8452110	D18L13	7/32	6	5,500	4,400	3,200	7,000	5,700	4,000	
8452110	D18L13	9/32	7	9,100	7,400	5,200	11,200	9,100	6,400	
8452210	D22L16	5/16	8	11,700	9,500	6,800	14,800	12,100	8,500	
8452310	D26L20	3/8	10	18,400	15,100	10,600	22,900	18,700	13,200	
8452410	D32L22	1/2	13	31,200	25,500	18,000	39,000	31,800	22,500	
8452510	D38L26	5/8	16	47,000	38,400	27,100	58,700	47,900	33,900	
8452610	D50L32	3/4	20	73,500	60,000	42,400	91,700	74,900	53,000	
8452710	D56L36	7/8	22	88,900	72,500	51,300	110,900	90,600	64,000	

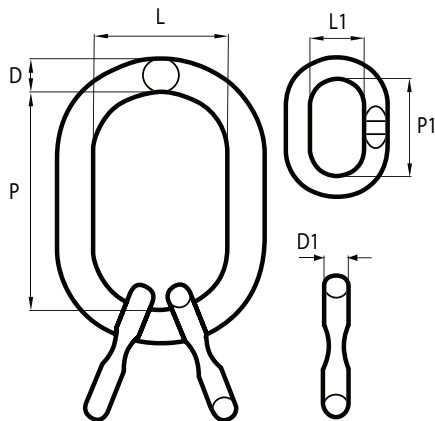

# V10™ ALLOY CHAIN ACCESSORIES

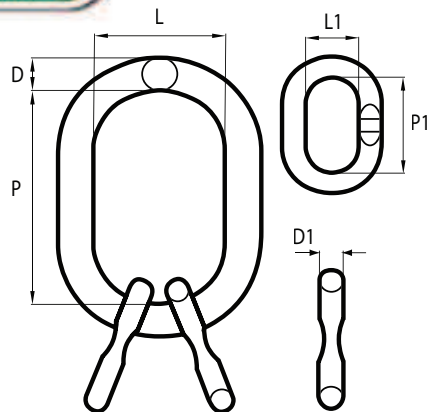

## Sub-Assemblies w/Large Sub-Links

Stock #	Mfr. #	Trade Size		Dimensions (Inches)						Lbs. Per Each	Working Load Limit	
		Inches	MM	D	P	L	D1	P1	L1		5:1 Safety Factor (lbs.)	4:1 Safety Factor (lbs.)
8452100	D18E14	3/4	19	0.748	5.315	2.953	0.591	4.724	2.756	4.3	8,960	11,200
8452200	D22E16	7/8	22	0.906	6.299	3.543	0.669	5.512	3.150	6.9	12,160	15,200
8452300	D26E20	1	26	1.063	7.087	3.937	0.787	6.299	3.740	10.9	18,320	22,900
8452400	D32E26	1-1/4	32	1.299	7.874	4.331	1.063	7.480	4.331	21.0	31,760	39,700
8452500	D38E32	1-1/2	38	1.496	10.827	5.906	1.299	9.055	5.118	37.5	48,880	61,100
8452600	E50D38	2	50	1.969	13.780	9.843	1.496	10.827	5.906	71.9	73,360	91,700
8452700	D56D45	2-1/4	56	2.205	13.780	9.843	1.772	13.386	7.087	106.1	88,720	110,900

## Sub-Assemblies w/Large Sub-Links \*4:1 Safety Factor for Chain Slings

Stock #	Blue	Mfr. #	Chain Size		G80 Triple & Quad Leg			G100 Triple & Quad Leg		
			Inches	MM	*WLL @ 60° (Lbs.)	*WLL @ 45° (Lbs.)	*WLL @ 30° (Lbs.)	*WLL @ 60° (Lbs.)	*WLL @ 45° (Lbs.)	*WLL @ 30° (Lbs.)
8452100	D18E14	7/32	6	5,500	4,400	3,200	7,000	5,700	4,000	
8452100	D18E14	9/32	7	9,100	7,400	5,200	11,200	9,100	6,400	
8452200	D22E16	5/16	8	11,700	9,500	6,800	14,800	12,100	8,500	
8452300	D26E20	3/8	10	18,400	15,100	10,600	22,900	18,700	13,200	
8452400	D32E26	1/2	13	31,200	25,500	18,000	39,000	31,800	22,500	
8452500	D38E32	5/8	16	47,000	38,400	27,100	58,700	47,900	33,900	
8452600	E50D38	3/4	20	73,500	60,000	42,400	91,700	74,900	53,000	
8452700	D56D45	7/8	22	88,900	72,500	51,300	110,900	90,600	64,000	



Do not exceed Working Load Limits (WLL)!  
See the SAFETY GUIDELINES section before using these products. Pages 150 - 155.



# OVERHEAD LIFTING

## V10™ Grade 100 Alloy Chain Accessories

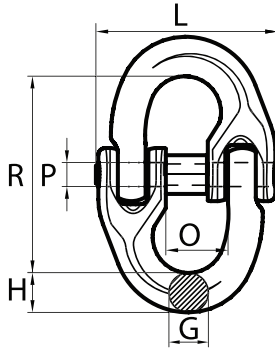

### Coupling Link\*

Stock #	Mfr. #	Chain Size		Dimensions (Inches)					Lbs. Per Each	WLL (Lbs.)
		Inches	MM	H	H	O	R	P X L		
8452900	WLK6	7/32	6	0.299	0.307	0.551	1.732	0.19 x 1.54	0.15	3,100
8453100	WLK7	9/32	7	0.354	0.394	0.669	2.008	0.24 x 1.85	0.26	4,300
8453000	WLK8	5/16	8	0.394	0.453	0.709	2.421	0.25 x 2.09	0.42	5,700
8453210	WLK10	3/8	10	0.496	0.543	0.886	2.835	0.32 x 2.48	0.84	8,800
8453300	WLK13	1/2	13	0.657	0.748	1.083	3.465	0.39 x 3.11	1.61	15,000
8453400	WLK16	5/8	16	0.827	0.827	1.299	4.055	0.55 x 4.17	3.15	22,600
8453510	WLK19-20	3/4	20	0.925	1.161	1.634	4.528	0.63 x 4.96	5.86	35,300
8453610	WLK22	7/8	22	1.063	1.142	1.909	5.315	0.63 x 5.75	8.29	42,700

\*Also available: non-V10 Grade 80 Coupling Links: 8053755 – 1", 8053855 – 1-1/4"



### Eye Shortening Grab Hook

No reduction in working load limit. Presence of a chain shape groove for optimal chain position.

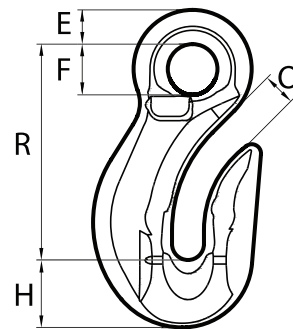

Stock #	Mfr. #	Chain Size		Dimensions (Inches)					Lbs. Per Each	WLL (Lbs.)
		Inches	MM	E	F	H	O	R		
8427100	GSE6	7/32	6	0.374	0.492	0.689	0.276	2.205	0.51	3,100
8427200	GSE7-8	9/32- 5/16	7-8	0.512	0.650	0.925	0.374	2.933	1.19	5,700
8427400	GSE10	3/8	10	0.630	0.827	1.142	0.472	3.661	2.34	8,800
8427600	GSE13	1/2	13	0.807	1.083	1.516	0.610	4.764	5.27	15,000
8427700	GSE16	5/8	16	0.984	1.319	1.890	0.728	5.846	9.88	22,600
8427800	GSE19-20	3/4	20	1.181	1.575	2.224	0.866	6.949	14.66	35,300
8427900	GSE22	7/8	22	1.299	1.732	2.441	1.024	7.657	19.29	42,700



# V10™ ALLOY CHAIN ACCESSORIES

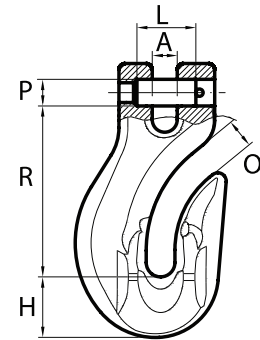

## Clevis Shortening Grab Hook

No reduction in working load limit. Presence of a chain shape groove for optimal chain position.

Stock #	Mfr. #	Chain Size		Dimensions (Inches)					Lbs. Per Each	WLL (Lbs.)
		Inches	MM	A	H	O	R	P X L		
8428100	GSC6	7/32	6	0.276	0.689	0.276	2.008	0.29 x 0.65	0.55	3,100
8428200	GSC7-8	9/32- 5/16	7-8	0.354	0.925	0.374	2.598	0.38 x 0.91	1.32	5,700
8428400	GSC10	3/8	10	0.453	1.142	0.472	3.228	0.49 x 1.16	2.51	8,800
8428610	GSC13	1/2	13	0.571	1.535	0.650	4.173	0.63 x 1.46	4.63	15,000
8428710	GSC16	5/8	16	0.709	1.811	0.866	5.118	0.79 x 2.05	8.38	22,600
8428810	GSC19-20	3/4	20	0.866	2.224	1.024	6.378	0.94 x 2.87	16.18	35,300
8428910	GSC22	7/8	22	0.984	2.480	1.161	7.008	1.06 x 2.80	21.01	42,700

## Clevis Shortening Grab Hook w/Retainer

No reduction in working load limit. Presence of a chain shape groove for optimal chain position.



8429100  
8429200  
8429400

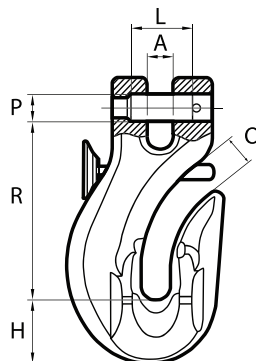

8429620  
8429720



**WARNING** Do not exceed Working Load Limits (WLL)! See the SAFETY GUIDELINES section before using these products. Pages 150 - 155.

# OVERHEAD LIFTING



## EyeGrab Hook w/Clevis Attachment

No reduction in working load limit. Presence of a chain shape groove for optimal chain position.

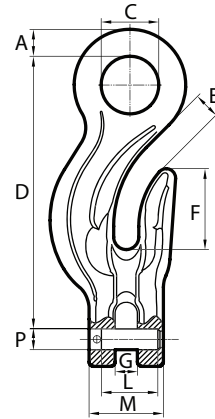

Stock #	Mfr. #	Chain Size		Dimensions (Inches)								Lbs. Per Each	WLL (Lbs.)
		In.	MM	A	F	G	H	O	O1	R	P X L		
8420100	GIE6	7/32	6	0.256	0.709	0.303	0.406	0.315	0.315	3.484	0.29 x 0.65	0.60	3,100
8420200	GIE7-8	9/32-5/16	7-8	0.358	0.945	0.378	0.531	0.362	0.354	4.606	0.38 x 0.91	1.35	5,700
8420400	GIE10	3/8	10	0.453	1.220	0.472	0.630	0.539	0.531	5.827	0.49 x 1.16	2.69	8,800
8420600	GIE13	1/2	13	0.571	1.457	0.610	0.787	0.638	0.610	7.283	0.63 x 1.46	5.62	15,000
8420700	GIE16	5/8	16	0.689	1.890	0.807	1.043	0.843	0.787	9.134	0.79 x 2.05	10.80	22,600

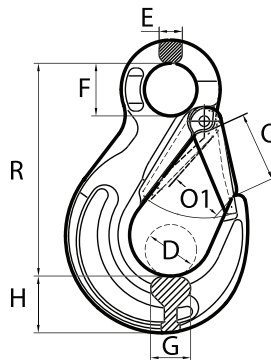

## Eye Sling Hook w/Latch\*

Stock #	Mfr. #	Chain Size		Dimensions (Inches)								Lbs. Per Each	WLL (Lbs.)
		Inches	MM	D	E	F	G	H	O	O1	R		
8417100	SHE6	7/32	6	0.709	0.394	0.787	0.650	0.827	0.984	0.748	3.327	0.73	3,100
8417200	SHE7-8	9/32-5/16	7-8	0.945	0.433	0.984	0.748	1.063	1.260	0.984	4.173	1.23	5,700
8417400	SHE10	3/8	10	1.181	0.630	1.339	1.024	1.299	1.575	1.220	5.157	2.65	8,800
8417600	SHE13	1/2	13	1.496	0.748	1.693	1.299	1.654	1.890	1.535	6.457	5.18	15,000
8417700	SHE16	5/8	16	1.732	0.984	1.969	1.575	1.969	2.165	1.772	7.185	8.20	22,600
8417800	SHE19-20	3/4	20	2.087	1.063	2.165	1.890	2.126	2.402	2.126	8.071	13.12	35,300
8417900	SHE22	7/8	22	2.362	1.142	2.362	1.969	2.402	2.795	2.402	8.858	17.35	42,700

\*Also available: non-V10 Grade 100 Eye Sling Hook: 8417500 - 1"



Do not exceed Working Load Limits (WLL)! See the SAFETY GUIDELINES section before using these products. Pages 150 - 155.

# V10™ ALLOY CHAIN ACCESSORIES

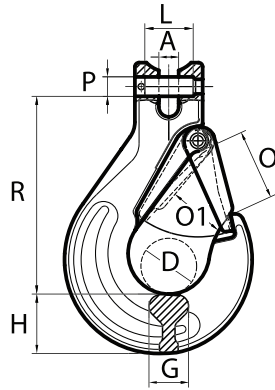

## Clevis Sling Hook w/Latch

Stock #	Mfr. #	Chain Size		Dimensions (Inches)								Lbs. Per Each	WLL (Lbs.)
		Inches	MM	A	D	G	H	O	O1	R	P X L		
8418100	SHC6	7/32	6	0.276	0.709	0.650	0.787	0.984	0.748	2.717	0.29 x 0.65	0.60	3,100
8418200	SHC7-8	9/32- 5/16	7-8	0.354	0.984	0.748	1.102	1.260	1.024	3.720	0.38 x 0.91	1.35	5,700
8418400	SHC10	3/8	10	0.453	1.181	0.984	1.299	1.535	1.220	4.291	0.49 x 1.16	2.47	8,800
8418600	SHC13	1/2	13	0.571	1.496	1.181	1.575	1.890	1.535	5.315	0.63 x 1.46	4.52	15,000
8418700	SHC16	5/8	16	0.689	1.732	1.457	1.850	2.165	1.772	6.102	0.79 x 2.05	7.50	22,600
8418800	SHC19-20	3/4	20	0.906	2.047	2.008	1.969	2.402	2.087	7.205	0.94 x 2.87	13.80	35,300
8418900	SHC22	7/8	22	0.965	2.362	1.969	2.402	2.795	2.402	8.346	1.06 x 2.80	19.32	42,700

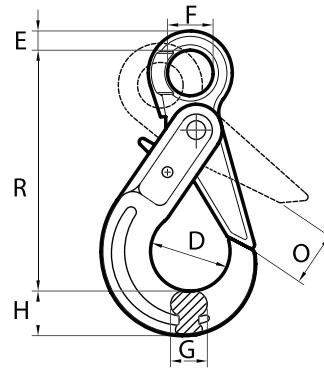

## Eye Self-Locking Hook

Stock #	Mfr. #	Chain Size		Dimensions (Inches)								Lbs. Per Each	WLL (Lbs.)
		In	MM	D	E	F	G	H	O	R			
8497100	SKE6	7/32	6	1.378	0.433	0.827	0.630	0.807	1.102	4.331	1.17	3,100	
8497200	SKE7-8	9/32- 5/16	7-8	1.713	0.472	1.063	0.787	1.024	1.339	5.354	1.96	5,700	
8497400	SKE10	3/8	10	2.205	0.591	1.358	0.965	1.181	1.772	6.634	3.48	8,800	
8497600	SKE13	1/2	13	2.717	0.787	1.575	1.358	1.575	2.028	8.071	6.97	15,000	
8497700	SKE16	5/8	16	3.150	1.063	1.969	1.398	1.969	2.362	9.902	13.34	22,600	



Do not exceed Working Load Limits (WLL)!  
See the SAFETY GUIDELINES section before using these products. Pages 150 - 155.

# OVERHEAD LIFTING



## Clevis Self-Locking Hook

Stock #	Mfr. #	Chain Size		Dimensions (Inches)							Lbs. Per Each	WLL (Lbs.)
		Inches	MM	A	D	G	H	O	R	P X L		
8498100	SKC6	7/32	6	0.264	1.378	0.630	0.807	1.102	3.700	0.29 x 0.65	1.10	3,100
8498200	SKC7-8	9/32-5/16	7-8	0.335	1.713	0.787	1.024	1.339	4.843	0.38 x 0.91	2.12	5,700
8498400	SKC10	3/8	10	0.472	2.205	0.965	1.181	1.772	5.650	0.49 x 1.16	3.53	8,800
8498600	SKC13	1/2	13	0.591	2.717	1.358	1.575	2.028	7.067	0.63 x 1.46	6.90	15,000
8498800	SKC16	5/8	16	0.748	3.150	1.398	1.969	2.362	8.543	0.79 x 2.05	12.79	22,600

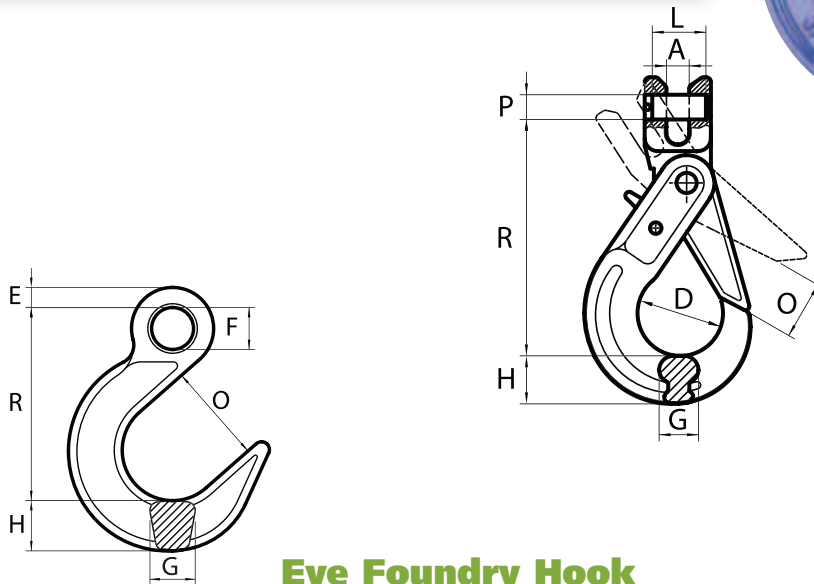

## Eye Foundry Hook

Stock #	Mfr. #	Chain Size		Dimensions (Inches)						Lbs. Per Each	WLL (Lbs.)
		Inches	MM	E	F	G	H	O	R		
8477200	FHE7-8	9/32- 5/16	7-8	0.531	0.709	1.024	1.220	2.520	4.823	2.49	5,700
8477400	FHE10	3/8	10	0.630	0.866	1.260	1.417	3.071	5.866	4.39	8,800
8477600	FHE13	1/2	13	0.748	1.063	1.535	1.693	3.504	6.949	7.30	15,000
8477700	FHE16	5/8	16	0.945	1.260	1.772	1.969	3.937	8.071	11.69	22,600
8477800	FHE19-20	3/4	20	1.063	1.496	2.008	2.402	4.528	9.331	16.98	35,300

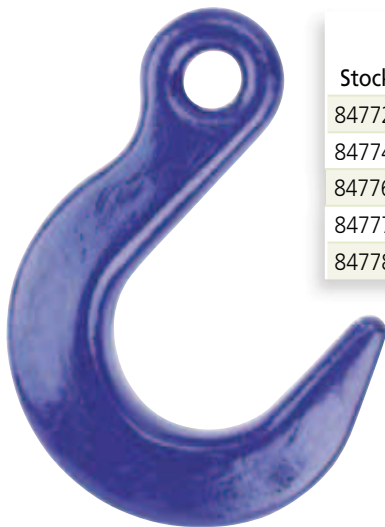

**WARNING** Do not exceed Working Load Limits (WLL)! See the SAFETY GUIDELINES section before using these products. Pages 150 - 155.

# V10™ ALLOY CHAIN ACCESSORIES



## Swivel Self-Locking Hook

Stock #	Mfr. #	Chain Size		Dimensions (Inches)							Lbs. Per Each	WLL (Lbs.)
		Inches	MM	D	E	F	G	H	O	R		
8499100	SKS6	7/32	6	1.377	0.512	1.377	0.630	0.807	1.102	6.299	1.76	3,100
8499200	SKS7-8	9/32- 5/16	7-8	1.713	0.512	1.378	0.787	1.024	1.339	7.126	2.43	5,700
8499400	SKS10	3/8	10	2.205	0.630	1.654	0.965	1.181	1.772	8.583	4.41	8,800
8499600	SKS13	1/2	13	2.717	0.787	1.929	1.358	1.575	2.028	10.591	8.82	15,000
8499700	SKS16	5/8	16	3.150	0.945	2.362	1.398	1.969	2.362	12.559	14.99	22,600

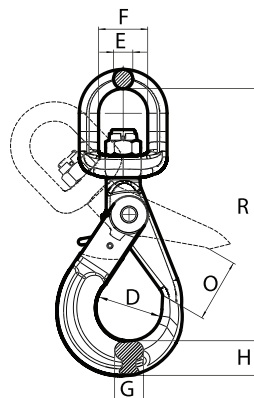
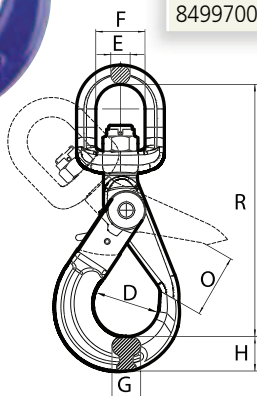

## Swivel Self-Locking Hook w/Bearing

Stock #	Mfr. #	Chain Size		Dimensions (Inches)							Lbs. Per Each	WLL (Lbs.)
		Inches	MM	D	E	F	G	H	O (Min.)	R		
8491100	SKB6	7/32	6	1.377	0.512	1.377	0.630	0.807	1.102	6.299	1.76	3,100
8491200	SKB7-8	9/32- 5/16	7-8	1.713	0.512	1.378	0.787	1.024	1.339	7.126	2.43	5,700
8491400	SKB10	3/8	10	2.205	0.630	1.654	0.965	1.181	1.772	8.583	4.41	8,800
8491600	SKB13	1/2	13	2.717	0.787	1.929	1.358	1.575	2.028	10.591	8.82	15,000
8491700	SKB16	5/8	16	3.150	0.945	2.362	1.398	1.969	2.362	12.559	14.99	22,600



## Spare Pin & Collar Set for Coupling Links

Stock #	Dia. X Length (Inches)	Use W/Stock #
8453199	0.236 x 1.831	8453100
8453099	0.248 x 2.087	8453000
8453299	0.315 x 2.492	8453200
8453399	0.394 x 3.110	8453300
8453499	0.551 x 4.173	8453400
8453589	0.630 x 4.823	8453510
8453699	0.630 x 5.650	8453600



**WARNING** Do not exceed Working Load Limits (WLL)! See the SAFETY GUIDELINES section before using these products. Pages 150 - 155.



## Clevis Hook Pin Kits

Stock #	Dia. X Length (Inches)	Use W/Stock #
8410299	0.354 x 0.906	8428200
		8418200
		8498200
8410499	0.492 x 1.161	8428400
		8418400
		8498400
8410599	0.630 x 1.457	8428600
		8418600
		8498600
8410699	0.787 x 2.047	8428700
		8418700
		8498800
8410799	0.945 x 2.874	8428800
		8418800
		8428900
8410899	1.063 x 2.795	8418900

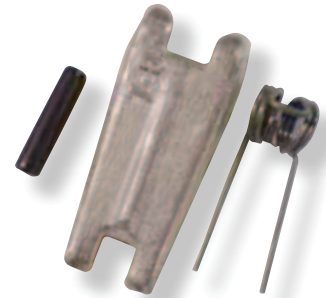

## Sling Hook Latch Kits

Stock #	Use W/Stock #
8410077	8417100
	8418100
8410177	8417200
	8418200
8410277	8417400
	8418400
8410377	8417600
	8418600
8410477	8417700
	8418700
8410577	8417800
	8418800
8410677	8417900
	8418900

## Self-Locking Hook Trigger Kit



Stock #	Use W/Stock #
8490199	8491100
	8498100
	8418100
	8497100
8490299	8491200
	8498200
	8497200
	8499200
8490399	8491400
	8498400
	8497400
8490499	8499400
	8491600
	8498600
	8497600
8490599	8499600
	8491700
	8498800
	8497700
	8499700

## Replacement Pins for Retainer Pin Grab Hooks

Stock #	Use W/Stock #
8429105	8429100
8429205	8429200
8429405	8429400
8429605	8429600
8429625	8429620
8429705	8429700
8429725	8429720



Do not exceed Working Load Limits (WLL)!  
See the SAFETY GUIDELINES section before using these products. Pages 150 - 155.



# PEER-LIFT ALLOY CHAIN ACCESSORIES

## PEER-Lift Grade 80 Alloy Chain Accessories

PROOF TESTED AT TWICE THE WORKING LOAD LIMIT. FATIGUE TESTED AT 1.5 TIMES THE WORKING LOAD LIMIT FOR 20,000 CYCLES. MEET OR EXCEED ASTM A952 AND OSHA 1910 STANDARDS.

### Eye Cradle Grab Hook

Stock #	Chain Size		Dimensions (Inches)				Lbs. Per Each	WLL (Lbs.)
	Inches	MM	A	B	C	D		
8527280	9/32	7	0.390	2.360	0.590	0.350	0.5	3,500
8527480	3/8	10	0.510	3.330	0.790	0.510	1.3	7,100
8527680	1/2	13	0.630	4.090	0.980	0.590	2.7	12,000
8527780	5/8	16	0.710	4.490	1.180	0.790	4.4	18,100

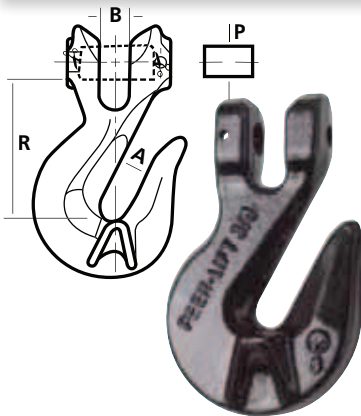
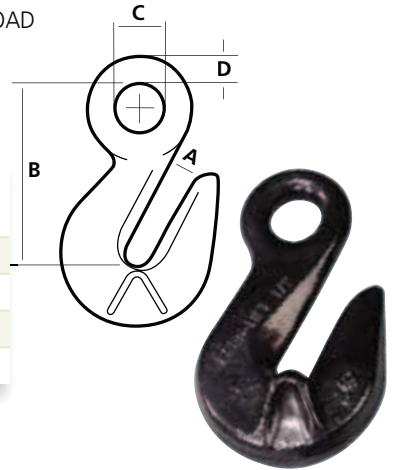

### Clevis Cradle Grab Hook

Stock #	Chain Size		Dimensions (Inches)				Lbs. Per Each	WLL (Lbs.)
	Inches	MM	A	B	P	R		
8528280	9/32	7	0.391	0.391	0.359	1.078	0.8	3,500
8528480	3/8	10	0.516	0.516	0.484	2.719	1.7	7,100
8528680	1/2	13	0.625	0.625	0.625	3.234	3.2	12,000
8528780	5/8	16	0.719	0.719	0.703	3.938	6.4	18,100

### Eye Sling Hook with Latch\*

Stock #	Chain Size		Dimensions (Inches)				Lbs. Per Each	WLL (Lbs.)
	Inches	MM	A	B	C	D		
8517280	9/32	7	1.390	4.560	1.120	0.480	1.5	3,500
8517480	3/8	10	1.840	5.680	1.410	0.630	3.0	7,100
8517680	1/2	13	2.200	7.260	1.750	0.730	4.2	12,000
8517780	5/8	16	2.500	8.680	2.120	1.000	10.4	18,100

\*Replacement Latch Kits: 9/32"- 8518230 • 3/8"- 8518430 • 1/2"- 8518630 • 5/8"- 8518730

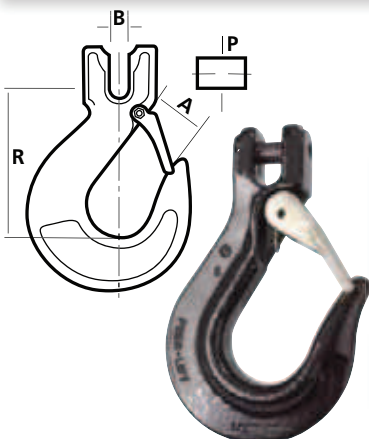
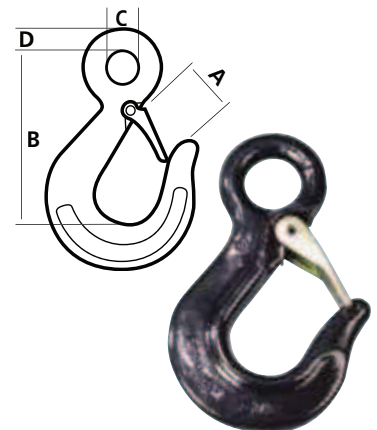

### Clevis Sling Hook with Latch\*

Stock #	Chain Size		Dimensions (Inches)				Lbs. Per Each	WLL (Lbs.)
	Inches	MM	A	B	P	R		
8518280	9/32	7	1.188	0.375	0.354	3.906	1.1	3,500
8518480	3/8	10	1.516	0.500	0.516	4.719	3.2	7,100
8518680	1/2	13	1.813	0.609	0.625	6.109	5.9	12,000
8518780	5/8	16	2.469	0.734	0.703	7.188	7.9	18,100

\*Replacement Latch Kits: 9/32"- 8518230 • 3/8"- 8518430 • 1/2"- 8518630 • 5/8"- 8518730



Do not exceed Working Load Limits (WLL)! See the SAFETY GUIDELINES section before using these products. Pages 150 - 155.





## Mechanical Coupling Link

Stock #	Chain Size		Dimensions (Inches)					Lbs. Per Each	WLL (Lbs.)
	Inches	MM	A	B	C	D	E		
8553180	9/32	7	0.344	2.109	0.844	0.828	0.828	0.3	3,500
8553280	3/8	10	0.469	2.625	3.047	1.016	0.984	0.8	7,100
8553380	1/2	13	0.625	3.438	1.391	1.297	1.219	1.7	12,000
8553480	5/8	16	0.797	4.000	1.656	1.625	1.531	3.0	18,100

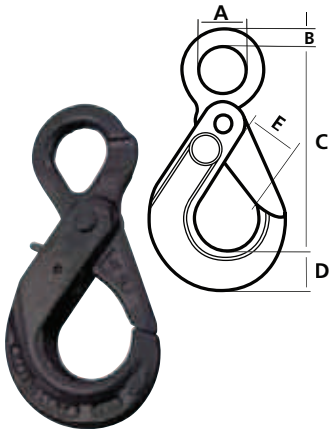
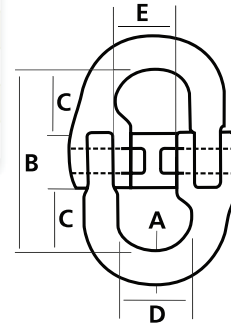

## Eye Self-Locking Hook\*

Stock #	Chain Size		Dimensions (Inches)					Lbs. Per Each	WLL (Lbs.)
	Inches	MM	A	B	C	D	E		
8597280	9/32	7	0.940	0.450	5.270	0.980	1.270	1.8	3,500
8597480	3/8	10	1.260	0.590	6.710	1.310	1.800	3.7	7,100
8597680	1/2	13	1.570	0.790	8.200	1.640	2.110	6.8	12,000
8597780	5/8	16	1.970	0.910	10.000	2.050	2.520	13.9	18,100

\*Replacement Trigger Kits: 9/32"- 8518230 • 3/8"- 8518430 • 1/2"- 8518630 • 5/8"- 8518730

## Clevis Self-Locking Hook\*

Stock #	Chain Size		Dimensions (Inches)					Lbs. Per Each	WLL (Lbs.)
	Inches	MM	A	B	C	D	E		
8598280	9/32	7	0.380	0.390	4.800	0.980	1.270	1.8	3,500
8598480	3/8	10	0.500	0.470	6.040	1.310	1.800	3.8	7,100
8598680	1/2	13	0.600	0.630	7.340	1.640	2.110	7.1	12,000
8598880	5/8	16	0.730	0.790	8.460	2.050	2.520	13.8	18,100

\*Replacement Trigger Kits: 9/32"- 8518230 • 3/8"- 8518430 • 1/2"- 8518630 • 5/8"- 8518730

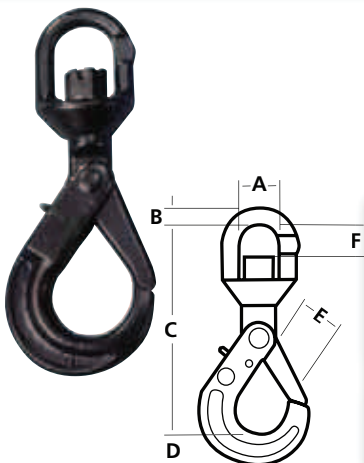
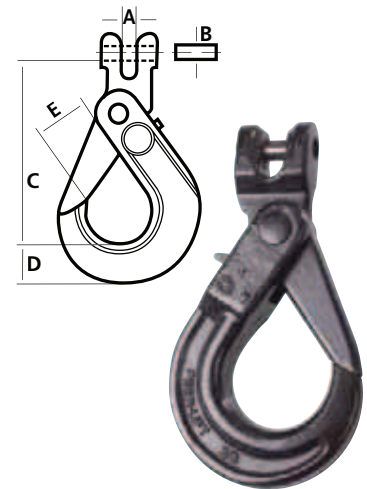

## Swivel Self-Locking Hook\*

Stock #	Chain Size		Dimensions (Inches)						Lbs. Per Each	WLL (Lbs.)
	Inches	MM	A	B	C	D	E	F		
8599280	9/32	7	1.380	0.470	7.000	0.980	1.270	1.000	2.6	3,500
8599480	3/8	10	1.570	0.590	8.670	1.310	1.800	1.300	5.1	7,100
8599680	1/2	13	1.890	0.770	10.940	1.620	2.130	1.630	9.7	12,000
8599780	5/8	16	2.360	0.860	13.130	2.050	2.520	2.050	18.4	18,100

\*Replacement Trigger Kits: 9/32"- 8518230 • 3/8"- 8518430 • 1/2"- 8518630 • 5/8"- 8518730



Do not exceed Working Load Limits (WLL)!  
See the SAFETY GUIDELINES section before using these products. Pages 150 - 155.



# PEER-LIFT ALLOY CHAIN ACCESSORIES

## Peer-Lift Alloy Screw Pin Anchor Shackles

Forged Alloy Body & Pin (RR-C271F, Type IVA, Grade B, Class 2)

- Meet or exceed FED SPEC RR-C-271 requirements
- Meet ASME B30.26 Requirements
- Hot Dipped Galvanized to ASTM A153
- Proof load at 2 times Working Load Limit
- Ultimate load at 6 times the Working Load Limit

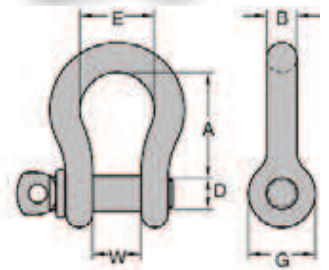

Stock #	Trade Size (Inches)	Pin Dia. (D)	W	A	E (Min.)	G (Max.)	B (Min.)	Qty. Per Package	Lbs. Per Each	Working Load Limit (Ton)
8058103	3/16	1/4	0.375	0.875	0.560	0.620	0.180	250	0.1	1/2
8058203	1/4	5/16	0.470	1.125	0.750	0.875	0.240	250	0.1	3/4
8058303	5/16	3/8	0.530	1.250	0.810	1.000	0.300	150	0.2	1-1/4
8058403	3/8	7/16	0.655	1.435	0.940	1.120	0.360	100	0.3	2
8059203	7/16	1/2	0.720	1.685	1.060	1.250	0.420	100	0.5	2-2/3
8058503	1/2	5/8	0.815	1.875	1.190	1.380	0.480	50	0.7	3-1/3
8058603	5/8	3/4	1.065	2.405	1.500	1.880	0.590	25	1.4	5
8058703	3/4	7/8	1.250	2.825	1.750	2.120	0.710	25	2.4	7
8058803	7/8	1	1.500	3.310	2.000	2.370	0.830	10	3.6	9-1/2
8058903	1	1-1/8	1.690	3.750	2.310	2.620	0.950	10	5.1	12-1/2
8059003	1-1/4	1-3/8	2.030	4.690	2.880	3.250	1.190	5	9.5	18
8059103	1-1/2	1-5/8	2.375	5.750	3.380	3.750	1.420	5	17.7	30
8059403	1-3/4	2	2.875	7.000	4.500	4.500	1.660	1	30.4	40
8059503	2	2-1/4	3.250	7.750	5.250	5.250	1.900	1	45.0	50

## Alloy Chain Accessories

### Metal ID Tags For Slings

#### Instructions for Assembling:

Punch the information onto the tag as it relates to reach, working load limit, size and serial number.

Stock #	Description	Finish	Dimensions (Inches)		Carton Qty.
			Length	Width	
440900009	Forged ID Tag w/wire rope & sleeve conn.	Self-Colored	4.75	1.38	50
440900003	Forged ID Tag	Self-Colored	4.75	1.38	100
599920003	Stamped ID Tag w/wire rope & sleeve conn.	Bright Zinc	4.00	1.75	50
8055435	Solid Ring Stamped ID Tag	Bright Zinc	4.00	1.50	50
8055535	Split Ring Stamped ID Tag	Bright Zinc	4.00	1.50	50

440900009



440900003

599920003



8055435



Do not exceed Working Load Limits (WLL)!  
See the SAFETY GUIDELINES section before using these products. Pages 150 - 155.

# CUSTOM LIFTING

Alloy Custom Lifting Components.....	32-36
Stainless Custom Lifting Components	37-40
Plate Hooks .....	41
Insulated Swivel Hooks .....	42
Magnet Chain Assemblies .....	42-43
Lifting Tongs .....	44
Spreader Beams .....	44-46
Pallet Lifters .....	47
Coil Lifters .....	48-49



# CUSTOM LIFTING PEERLESS CUSTOM LIFTING COMPONENTS



## Custom Lifting Solutions

Peerless Custom Lifting, with divisions in Jeannette, PA and South Holland, IL, is capable of satisfying your custom lifting needs from welded chains slings to motorized coil lifters and much more.

We can design and construct a specialized lifting device to fit your application from carbon, alloy, stainless, aluminum or other specialty steels. Our experienced sales and engineering staff are available to solve all of your below the hook lifting requirements.

- Certified to OSHA and ASME standards.
- Capable of manufacturing to government and military specifications.
- Horizontal proof test capabilities up to 1,200,000 lbs and 40 feet in length.
- Vertical proof test capabilities up to 450,000 lbs.



Do not exceed Working Load Limits (WLL)! See the SAFETY GUIDELINES section before using these products. Pages 150 - 155.

# CUSTOM LIFTING

## V-Notched Alloy Coupling Links

Alloy components are 8620 or 4130 alloy steel. Un-heat treated coupling links are pre-notched, bright finished and ready for welding.

**NOT FOR OVERHEAD LIFTING.**

Stock #	Chain Size		Dimensions (Inches)			Lbs. Per Each
	Inches	MM	A	B	C	
CAN038	9/32	7	0.380	0.880	1.500	0.20
CAN050	3/8	10	0.500	1.250	2.000	0.40
CAN069	1/2	13	0.690	1.500	2.500	0.90
CAN081	5/8	16	0.810	1.750	3.000	1.50
CAN094	3/4	20	0.940	2.000	3.500	2.30
CAN106	7/8	22	1.060	2.250	4.000	4.10
CAN125	1	26	1.250	3.000	5.250	6.00
CAN150	1-1/4	32	1.500	3.500	6.250	10.30
CAN175	1-1/2	38	1.750	4.000	7.000	15.90
CAN200	1-3/4	45	2.000	4.500	8.000	23.60
CAN225	2	50	2.250	5.000	9.000	33.50

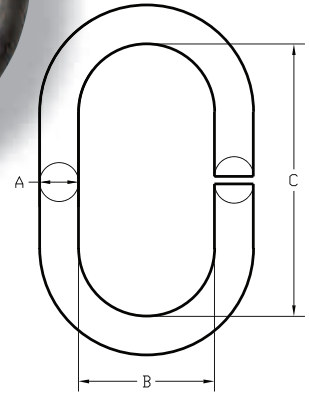

## Alloy Oblong Master Links

Alloy components are 8620 or 4130 alloy steel. Master links are welded, heat-treated, proof tested and tumble finished.

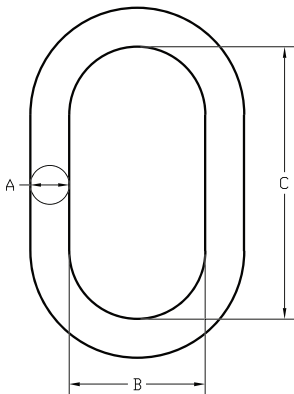

Stock #	Trade Size		Dimensions (Inches)			Lbs. Per Each	Working Load Limit (Lbs.)
	Inches	MM	A	B	C		
OMA041	13/32	10	0.410	1.500	3.000	0.40	3,600
OMA050	1/2	13	0.500	2.500	5.000	0.85	4,100
OMA063	5/8	16	0.630	3.000	6.000	1.60	6,100
OMA075	3/4	20	0.750	2.750	5.500	2.42	13,200
OMA100	1	26	1.000	3.500	7.000	4.70	22,500
OMA125	1-1/4	32	1.250	4.380	8.750	9.10	32,500
OMA150	1-1/2	38	1.500	5.250	10.500	18.50	49,000
OMA175	1-3/4	45	1.750	6.000	12.000	30.33	73,500
OMA200	2	50	2.000	7.000	14.000	43.40	88,900
OMA225	2-1/4	57	2.250	8.000	16.000	53.30	125,200
OMA250	2-1/2	64	2.500	8.000	16.000	66.70	147,300
OMA275	2-3/4	70	2.750	9.000	16.000	83.70	187,800





# PEERLESS CUSTOM LIFTING COMPONENTS

## Alloy Pear Shape Master Links



Alloy components are 8620 or 4130 alloy steel. Master links are welded, heat-treated, proof tested and tumble finished.

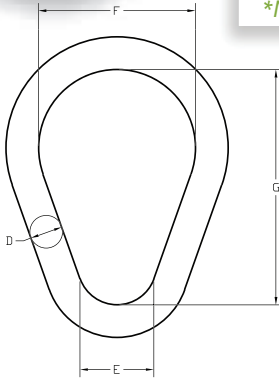

Stock #	Trade Size		Dimensions (Inches)				Lbs. Per Each	Working Load Limit (Lbs.)	
	Self-Colored	Inches	MM	D	E	F			G
PMA050		1/2	13	0.500	1.250	2.500	5.000	1.00	4,100
PMA063		5/8	16	0.630	1.500	3.000	6.000	1.50	6,600
PMA075		3/4	20	0.750	1.750	3.000	6.000	2.20	13,200
PMA100		1	26	1.000	2.500	4.000	8.000	5.10	22,500
PMA125		1-1/4	32	1.250	3.000	6.000	9.000	9.50	32,500
PMA150		1-1/2	38	1.500	5.500	7.000	10.500	16.20	49,000
PMA175		1-3/4	45	1.750	4.000	7.000	12.000	24.40	73,500
PMA200		2	50	2.000	4.000	7.000	14.000	42.66	88,900

*\*NAS specification Pear Shape Master Links available upon request.*



## Alloy Sub-Assemblies

Alloy components are 8620 or 4130 alloy steel. Master links are welded, heat-treated, proof tested and tumble finished.

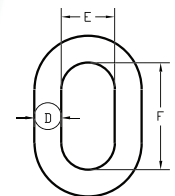

Stock #	Chain Size		Dimensions (Inches)						Lbs. Per Ea.	Working Load Limit (Lbs.)	
	Self-Colored	In.	MM	A	B	C	D	E			F
SMA028		9/32	7	0.750	2.750	5.500	0.500	1.250	2.000	2.90	13,200
SMA038		3/8	10	1.000	3.500	7.000	0.750	1.500	3.000	7.30	22,500
SMA050		1/2	13	1.250	4.380	8.750	1.000	2.000	4.000	16.33	32,500
SMA063		5/8	16	1.500	5.250	10.500	1.250	3.000	5.250	27.80	49,000
SMA075		3/4	20	1.750	6.000	12.000	1.500	3.250	5.750	51.00	73,500
SMA088		7/8	22	2.000	7.000	14.000	1.750	4.000	6.000	65.90	88,900
SMA100		1	26	2.250	8.000	16.000	1.880	4.000	7.000	90.55	125,200
SMA125		1-1/4	32	2.750	9.000	16.000	2.250	4.500	8.000	144.90	187,800

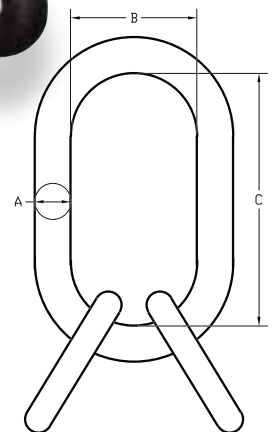

Do not exceed Working Load Limits (WLL)! See the SAFETY GUIDELINES section before using these products. Pages 150 - 155.

# CUSTOM LIFTING

## Alloy Round Rings

Alloy components are 8620 or 4130 alloy steel.

Stock #	Trade Size		Dimensions (Inches)		Lbs. Per Each	Working Load Limit (Lbs.)
	Inches	MM	A	B		
Self-Colored						
RMA050	1/2	13	0.500	2.500	0.58	4,300
RMA063	5/8	16	0.630	3.000	1.00	5,650
RMA075	3/4	20	0.750	4.000	2.00	8,600
RMA088	7/8	22	0.880	4.000	2.83	13,200
RMA100	1	26	1.000	4.000	3.40	19,000
RMA125	1-1/4	32	1.250	5.000	7.50	24,000
RMA150	1-1/2	38	1.500	6.000	12.00	37,000
RMA175	1-3/4	45	1.750	7.000	20.00	49,000
RMA200	2	50	2.000	8.000	29.00	60,000

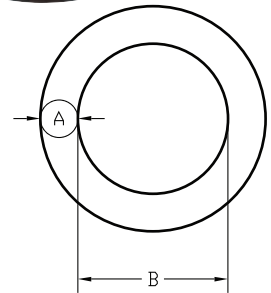

## Standard Alloy S-Hooks

Alloy components are 8620 or 4130 alloy steel.

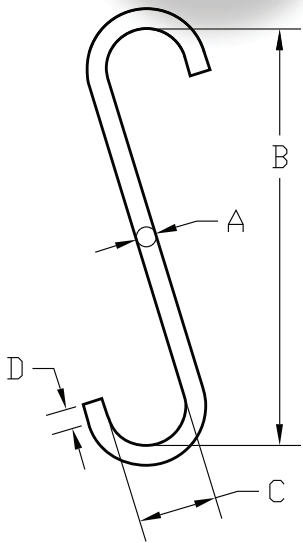

Stock #	Trade Size (Inches)	Dimensions (Inches)				Lbs. Per Each	Working Load Limit (Lbs.)
		A	B	C	D		
Self-Colored							
SHA0312	5/16	0.310	2.750	0.750	0.380	0.25	325
SHA0375	3/8	0.380	4.130	1.130	0.560	0.30	425
SHA0500	1/2	0.500	5.500	1.500	0.750	1.00	775
SHA0625	5/8	0.630	7.000	1.880	0.940	1.40	1,225
SHA0750	3/4	0.750	8.250	2.250	1.130	2.30	1,750
SHA0875	7/8	0.880	9.500	2.630	1.310	3.00	2,400
SHA1000	1	1.000	11.000	3.000	1.500	5.50	3,000
SHA1250	1-1/4	1.250	13.750	3.750	1.880	9.90	4,900
SHA1500	1-1/2	1.500	16.500	4.500	2.250	16.60	7,000
SHA1750	1-3/4	1.750	19.250	5.250	2.630	26.50	9,600
SHA2000	2	2.000	22.000	6.000	3.000	39.00	12,500
SHA2250	2-1/4	2.250	24.000	6.750	3.380	50.00	15,750
SHA2500	2-1/2	2.500	27.500	7.500	3.750	70.00	19,500
SHA2750	2-3/4	2.750	30.500	8.250	4.130	95.00	23,500



# PEERLESS CUSTOM LIFTING COMPONENTS



## Standard Alloy J-Hooks

Alloy components are 8620 or 4130 alloy steel.

Stock # (Self-Colored)			Trade Size (Inches)	Dimensions (Inches)					Lbs. Per Each	*WLL (Lbs.)
Style A	Style B	Style C		A	B	C	D	E		
JAA031	JBA031	JCA031	5/16	0.310	5.000	0.750	1.250	0.250	0.40	250
JAA038	JBA038	JCA038	3/8	0.380	6.000	0.750	1.500	0.380	0.42	350
JAA050	JBA050	JCA050	1/2	0.500	8.000	0.750	2.000	0.500	1.17	650
JAA063	JBA063	JCA063	5/8	0.630	9.000	1.000	2.500	0.630	1.50	850
JAA075	JBA075	JCA075	3/4	0.750	10.000	1.000	3.000	0.750	4.00	1,200
JAA088	JBA088	JCA088	7/8	0.880	12.000	1.000	3.500	0.880	5.00	1,500
JAA100	JBA100	JCA100	1	1.000	14.000	1.250	4.000	1.000	6.50	2,000
JAA113	JBA113	JCA113	1-1/8	1.130	15.000	1.250	4.500	1.120	7.90	2,250
JAA125	JBA125	JCA125	1-1/4	1.250	16.000	1.500	5.000	1.250	11.50	2,750
JAA138	JBA138	JCA138	1-3/8	1.380	17.000	1.500	5.500	1.380	14.20	3,000
JAA150	JBA150	JCA150	1-1/2	1.500	18.000	2.000	6.000	1.500	17.50	3,500
JAA175	JBA175	JCA175	1-3/4	1.750	20.000	2.500	7.000	1.750	27.50	4,000
JAA200	JBA200	JCA200	2	2.000	24.000	3.000	8.000	2.000	42.10	5,000

*\*Working Load Limit is based on bearing point to bearing point pull.*

STYLE A

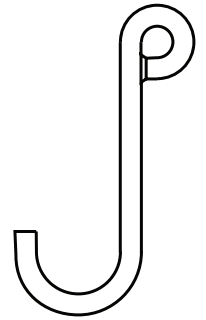

STYLE B

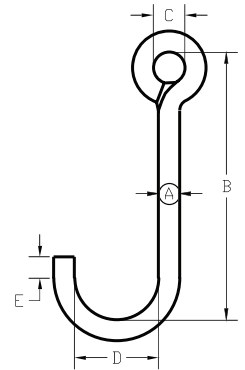

STYLE C

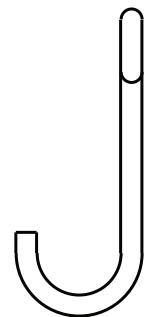

**WARNING** Do not exceed Working Load Limits (WLL)! See the SAFETY GUIDELINES section before using these products. Pages 150 - 155.





## Standard Alloy Foundry Sorting Hooks

Alloy components are 8620 or 4130 alloy steel.

Stock #	Chain Size (Inches)	Dimensions (Inches)					Lbs. Per Each	Working Load Limit (Lbs.)
		A	B	C	D	E		
FSA050	9/32	0.500	6.000	0.750	2.500	0.750	0.75	500
FSA063	9/32	0.630	8.500	0.750	3.500	1.500	1.40	800
FSA075	9/32	0.750	8.500	0.750	3.500	1.500	2.00	1,300
FSA081	3/8	0.810	8.500	0.880	3.500	1.500	2.67	1,600
FSA100	3/8	1.000	8.500	1.000	4.000	1.750	3.70	2,500
FSA113	3/8	1.130	8.500	1.000	4.000	2.000	5.00	3,500
FSA125	1/2	1.250	8.500	1.250	4.000	2.000	7.00	4,500
FSA150	1/2	1.500	8.500	1.250	5.000	1.500	9.50	6,000

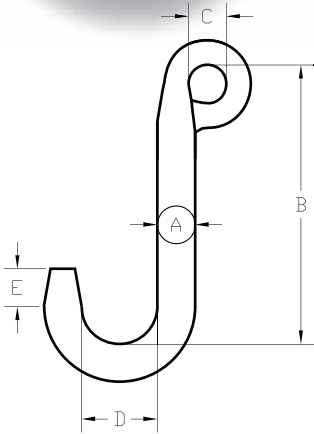

## Standard Alloy Foundry Sorting Hooks - Short Version

Alloy components are 8620 or 4130 alloy steel.

Stock #	Chain Size (Inches)	Dimensions (Inches)					Lbs. Per Each	Working Load Limit (Lbs.)
		A	B	C	D	E		
FSA050S	9/32	0.500	6.000	0.750	3.000	1.500	1.33	450
FSA063S	9/32	0.630	6.000	0.750	3.000	1.500	2.00	900
FSA075S	9/32	0.750	6.000	0.750	3.000	1.500	2.30	1,400
FSA081S	3/8	0.810	6.000	0.880	3.000	1.500	2.88	2,000
FSA100S	3/8	1.000	6.000	1.000	3.000	1.500	3.80	3,000
FSA113S	3/8	1.130	6.000	1.000	3.000	1.500	4.70	4,000
FSA125S	1/2	1.250	6.000	1.250	3.000	1.500	6.30	5,500

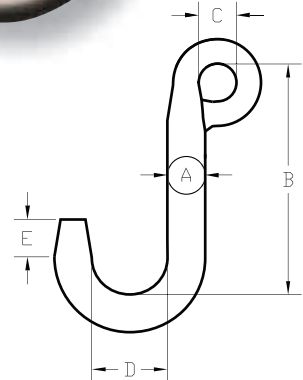



## Grade 50 Stainless Chain

Stock #	Trade Size (Inches)	Wire Dia. (Inches)	Inside Link Dim. (Inches)		Ft. Per Drum	Lbs. Per Foot	Working Load Limit	
			Length (Nominal)	Width (Min.)			Lbs.	Kgs.
CHS012	1/8	0.130	0.890	0.290	1,000	0.22	375	170
CHS019	3/16	0.190	0.950	0.400	800	0.40	1,200	544
CHS025	1/4	0.250	1.000	0.500	400	0.71	2,000	907
CHS031	5/16	0.310	1.100	0.500	275	1.05	2,850	1,293
CHS038	3/8	0.380	1.230	0.630	200	1.50	3,550	1,610
CHS050	1/2	0.500	1.500	0.810	200	2.70	6,500	2,948
CHS063	5/8	0.630	1.870	1.000	150	3.71	9,500	4,309
CHS075	3/4	0.750	2.120	1.130	---	5.80	15,000	6,804
CHS100	1	1.000	3.580	1.370	---	8.53	22,500	10,206

## Chain Sling Working Load Limit Specifications

Grade 50 Stainless Steel Chain			
Chain Size Inches	Single Leg @ 90°	Double Leg @ 60°	Triple & Quad Leg @ 60°
3/16	1,200	2,075	2,850
1/4	1,250	2,150	3,225
5/16	1,900	3,275	---
3/8	2,650	4,575	6,875
1/2	4,500	7,775	11,675
5/8	6,000	10,375	15,575
3/4	10,000	17,300	25,975

- DO NOT** load an assembly in excess of the rated working load limits in the chart above.
- DO NOT** put an unequal load on one leg of a sling. Distribute the load evenly.
- DO NOT** expose assembly to impact, rapid lifts or sudden stops.
- DO NOT** tie knots or allow chains to become twisted.
- DO NOT** use chain that appears to be defective, worn or damaged.
- DO NOT** fasten chain over sharp corners or edges. Protect with padding.
- DO NOT** tip load hooks. The latch must NEVER support the load.

When using non-cradle or non-shortening grab hooks in a shortening or choker application, the Working Load Limit (WLL) of the sling must be reduced by 20% Reference the **Safety Guidelines** section of this catalog for more information.



Do not exceed Working Load Limits (WLL)! See the SAFETY GUIDELINES section before using these products. Pages 150 - 155.

# CUSTOM LIFTING

## 316 Stainless Steel V-Notch Coupling Links

V-Notch coupling links are electropolished and ready for welding.

Stock #	Chain Size		Dimensions (Inches)			Lbs. Per Each
	Inches	MM	A	B	C	
CS031	3/16	5.5	0.310	0.630	1.250	0.10
CS038	9/32	7	0.380	0.880	1.500	0.16
CS044	5/16	8	0.440	0.940	1.750	0.25
CS050	3/8	10	0.500	1.000	2.000	0.36
CS063	1/2	13	0.630	1.500	2.500	0.74
CS075	5/8	16	0.750	1.500	3.000	1.21
CS088	3/4	20	0.880	2.000	3.500	2.01
CS100	7/8	22	1.000	2.250	4.500	3.17
CS125	1	26	1.250	2.500	5.000	5.62

NOT FOR OVERHEAD LIFTING.

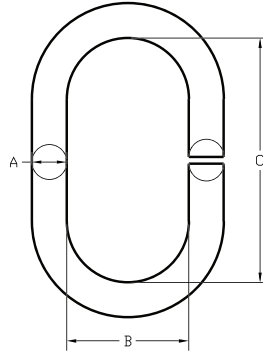

## 316 Stainless Steel Oblong Master Links

Welded, electropolished and proof tested.



Stock #	Trade Size		Dimensions (Inches)			Lbs. Per Each	Working Load Limit (Lbs.)
	Inches	MM	A	B	C		
OMS038	3/8	10	0.380	2.000	4.000	0.42	750
OMS050	1/2	13	0.500	2.500	5.000	0.94	2,150
OMS063	5/8	16	0.630	2.750	5.500	1.63	2,850
OMS075	3/4	20	0.750	3.000	6.000	2.50	4,600
OMS100	1	26	1.000	3.500	7.000	5.40	7,800
OMS125	1-1/4	32	1.250	4.000	8.000	8.75	11,800
OMS150	1-1/2	38	1.500	5.250	10.500	17.00	18,600

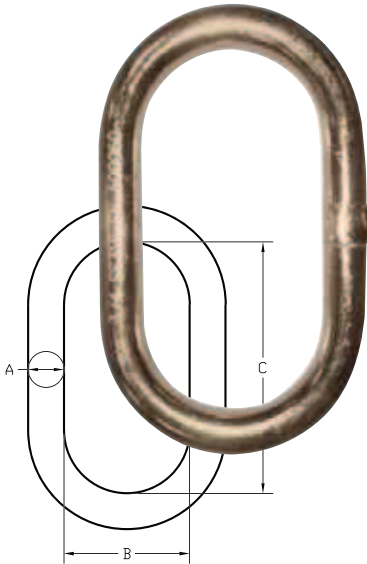

## 316 Stainless Steel Pear Shape Master Links

Welded, electropolished and proof tested.

Stock #	Trade Size		Dimensions (Inches)				Lbs. Per Each	Working Load Limit (Lbs.)
	Inches	MM	D	E	F	G		
PMS038	3/8	10	0.380	1.000	2.000	4.000	0.30	750
PMS050	1/2	13	0.500	1.250	2.500	5.000	0.80	2,150
PMS063	5/8	16	0.630	1.380	2.750	5.500	1.50	2,850
PMS075	3/4	20	0.750	1.500	3.000	6.000	2.10	4,600
PMS100	1	26	1.000	2.000	4.000	8.000	5.10	7,800
PMS125	1-1/4	32	1.250	3.000	6.000	9.000	9.60	11,800
PMS150	1-1/2	38	1.500	5.000	7.000	10.500	16.50	18,600

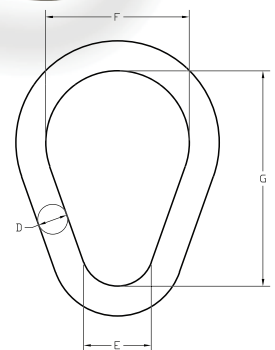



# PEERLESS CUSTOM LIFTING COMPONENTS

## 316 Stainless Steel Sub-Assemblies



Welded, electropolished and proof tested.

Stock #	Chain Size		Dimensions (Inches)						Lbs. Per Each	Working Load Limit (Lbs.) @ 60°
	In.	MM	A	B	C	D	E	F		
SMS019	3/16	5.5	0.630	2.750	5.500	0.380	0.880	1.500	2.00	2,850
SMS025	1/4	6	0.750	3.000	6.000	0.500	1.000	2.000	2.90	3,225
SMS038	3/8	10	1.000	3.500	7.000	0.750	1.500	3.000	7.10	6,875
SMS050	1/2	13	1.250	4.000	8.000	0.880	2.000	3.500	12.50	11,675
SMS063	5/8	16	1.500	5.250	10.500	1.120	2.500	5.000	15.00	15,575

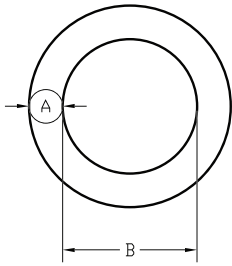
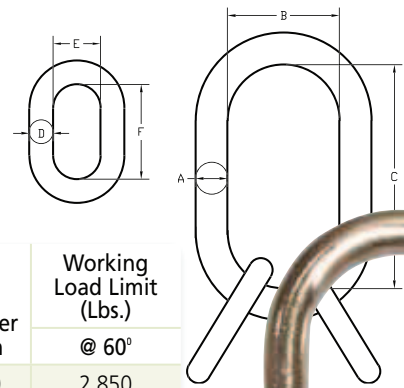

## 316 Stainless Steel Round Rings

Welded, electropolished and proof tested.

Stock #	Trade Size		Dimensions (Inches)		Lbs. Per Each	Working Load Limit (Lbs.)
	Inches	MM	A	B		
RMS038	3/8	10	0.380	2.000	0.23	750
RMS050	1/2	13	0.500	2.500	0.62	1,300
RMS063	5/8	16	0.630	3.000	1.20	1,850
RMS075	3/4	20	0.750	4.000	2.00	2,800
RMS100	1	26	1.000	4.000	4.00	5,650
RMS125	1-1/4	32	1.250	5.000	7.80	7,650
RMS150	1-1/2	38	1.500	6.000	13.40	9,700



## 316 Stainless Steel S-Hooks

Stock #	Trade Size	Dimensions (Inches)				Lbs. Per Each	Working Load Limit (Lbs.)
	Inches	A	B	C	D		
SS025	1/4	0.250	2.750	0.750	0.380	0.07	75
SS038	3/8	0.380	4.130	1.130	0.560	0.33	165
SS050	1/2	0.500	5.500	1.500	0.750	0.59	325
SS063	5/8	0.630	7.000	1.880	0.940	1.24	500
SS075	3/4	0.750	8.250	2.250	1.130	2.31	660
SS088	7/8	0.880	9.630	2.630	1.310	3.05	900
SS100	1	1.000	11.000	3.000	1.500	4.45	1,060

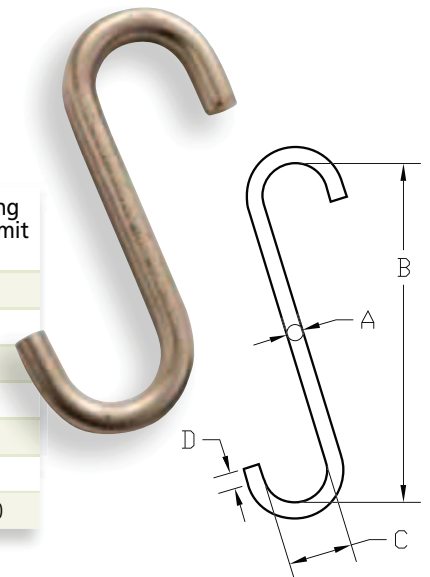

Do not exceed Working Load Limits (WLL)! See the SAFETY GUIDELINES section before using these products. Pages 150 - 155.



## 316 Stainless Steel Foundry Sorting Hooks

Welded, electropolished and proof tested.

Stock #	Trade Size (Inches)	Dimensions (Inches)					Lbs. Per Each	Working Load Limit (Lbs.)
		A	B	C	D	E		
SFS050	1/2	0.500	6.000	0.560	3.000	1.500	0.70	200
SFS063	5/8	0.630	6.000	0.560	3.000	1.500	1.10	300
SFS075	3/4	0.750	6.000	0.750	3.000	1.500	2.00	500
SFS100	1	1.000	6.000	0.750	3.000	1.500	3.00	900
SFS125	1-1/4	1.250	6.000	1.000	3.000	1.500	5.00	1,500

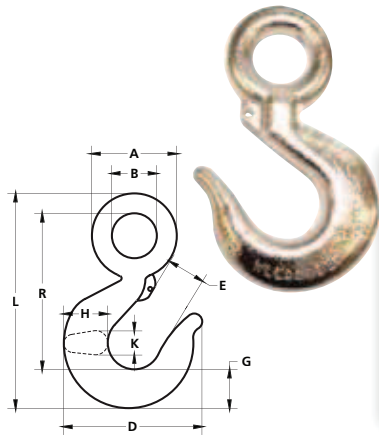
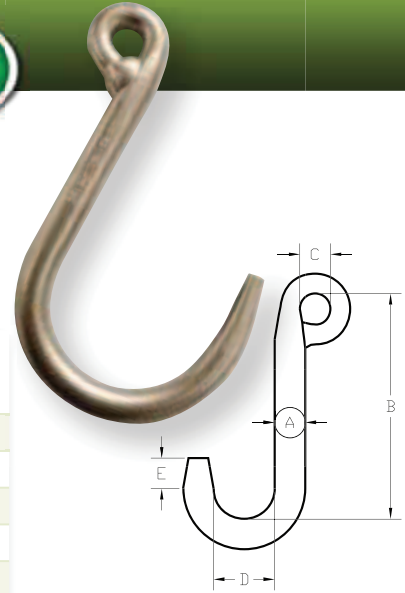

## 316 Stainless Steel Eye Sling Hooks

Stock #	Dimensions (Inches)										Lbs. Per Ea.	Working Load Limit (Lbs.)
	A	B	D	E	G	H	L	K	R			
RS25	1.500	0.750	3.000	0.880	0.880	0.880	4.380	0.560	3.190	0.60	1,250	
RS38	2.130	1.130	4.000	1.130	1.130	1.440	5.690	0.810	4.090	1.50	2,650	
RS50	2.500	1.250	4.690	1.250	1.340	1.750	6.690	1.130	4.690	2.50	4,500	
RS63	3.060	1.560	5.060	1.530	1.440	1.630	7.970	1.310	5.790	4.00	6,000	
RS75	3.880	2.000	6.500	1.810	1.810	2.060	10.130	1.750	7.320	7.30	10,000	

## 316 Stainless Steel Swivel Hooks

Stock #	Dimensions (Inches)											Lbs. Per Ea.	WLL (Lbs.)
	A	B	C	D	E	G	H	K	L	R	S		
SWS2	2.000	1.000	1.180	3.000	0.930	0.880	0.880	0.560	5.000	4.380	0.380	0.69	1,000
SWS3	2.500	1.380	1.380	3.190	1.060	0.880	0.970	0.630	5.500	5.250	0.500	1.40	1,500
SWS4	2.500	1.380	1.380	3.560	1.130	1.060	1.120	0.720	6.250	5.630	0.500	1.60	2,000
SWS5	3.000	1.630	1.690	3.880	1.250	1.200	1.310	0.810	6.970	6.500	0.630	1.80	2,500

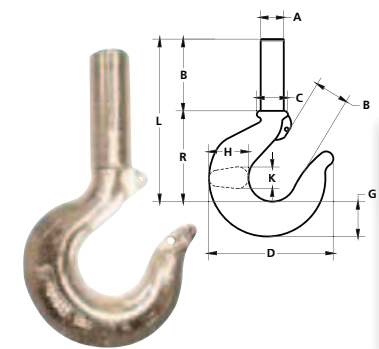
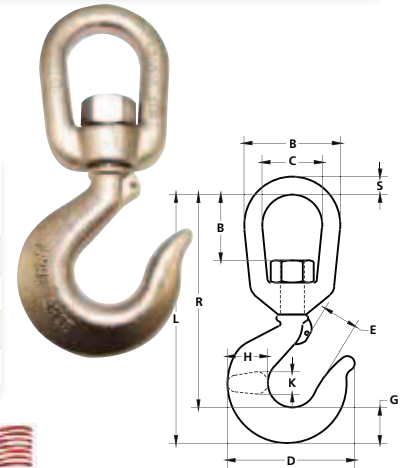

## 316 Stainless Steel Shank Hooks

Stock #	Dimensions (Inches)										Lbs. Per Ea.	WLL (Lbs.)
	A	B	C	D	E	G	H	K	L	R		
SHS2	0.560	2.000	0.690	3.000	0.930	0.880	0.880	0.560	5.000	2.310	0.64	1,000
SHS3	0.610	2.250	0.750	3.190	1.060	0.880	0.970	0.630	5.500	2.440	0.88	1,500
SHS4	0.720	2.500	0.880	3.560	1.130	1.060	1.120	0.720	6.250	2.750	1.10	2,000
SHS5	0.840	2.700	1.000	3.880	1.250	1.200	1.310	0.810	6.970	3.060	1.80	2,500



Do not exceed Working Load Limits (WLL)! See the SAFETY GUIDELINES section before using these products. Pages 150 - 155.

# PEERLESS CUSTOM LIFTING COMPONENTS



## Accoloy® Plate Hook

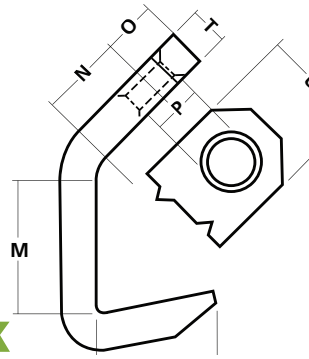

Accoloy Plate Hooks are designed for the most popular chain sizes - 9/32", 3/8", 1/2", 5/8" and 7/8". They are proof tested to the same values as the corresponding chain - therefore, the same working load limit applies. Fabricated from alloy steel, Plate Hooks can be furnished on Registered Slings as well as with various chain assemblies. Accoloy Plate Hooks are intended for use in handling plates, flats and structurals.

Stock #	Chain Size		Dimensions (Inches)							Lbs. Per Each	WLL (Lbs.)
	Inches	MM	L	M	N	O	P	T	U		
593400400	9/32	7	2.000	2.000	1.500	0.813	0.875	0.750	2.000	2.4	3,500
593400600	3/8	10	2.625	3.000	1.875	1.063	1.125	0.750	2.250	4.6	7,100
593400800	1/2	13	3.500	4.000	2.500	1.375	1.500	1.000	3.000	10.6	12,000
593401000	5/8	16	4.375	5.000	3.125	1.750	1.875	1.250	3.750	20.7	18,100
593401200	3/4	20	5.188	6.000	3.750	2.125	2.500	1.500	4.500	36.7	28,300
593401400	7/8	22	6.000	7.000	4.500	2.438	2.625	1.750	5.250	52.6	34,200

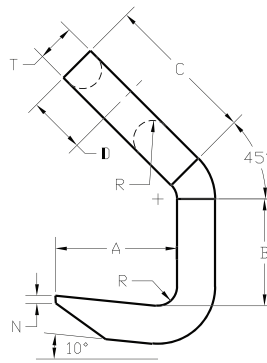
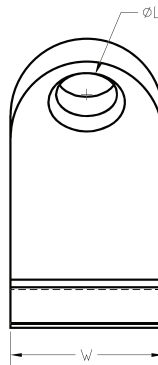
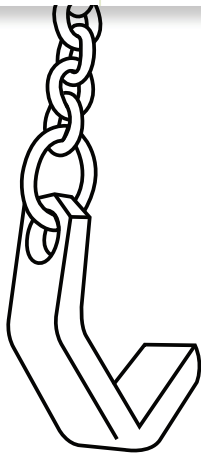

## Standard Plate Hook

Stock #	Chain Size		Dimensions (Inches)										Lbs. Per Each	WLL (Lbs.)
	Inches	MM	A	B	C	D	L	M	N	T	W	R		
PHA028	9/32	7	2.000	1.750	2.500	0.930	1.000	3.680	0.120	0.630	2.500	0.310	2.8	4,200
PHA038	3/8	10	2.625	3.000	4.310	1.180	1.120	6.380	0.180	0.750	2.750	0.380	5.7	7,400
PHA050	1/2	13	3.500	4.000	4.380	1.500	1.500	7.370	0.250	1.000	3.500	0.500	13.0	13,000
PHA063	5/8	16	4.375	5.000	5.430	1.870	1.880	9.250	0.310	1.250	5.000	0.630	26.5	20,400
PHA075	3/4	20	5.188	6.000	6.500	2.380	2.250	10.880	0.380	1.500	5.750	0.750	42.0	30,000
PHA088	7/8	22	6.000	7.000	7.630	2.500	2.630	13.680	0.430	1.750	6.000	1.000	65.0	40,000



Do not exceed Working Load Limits (WLL)!  
See the SAFETY GUIDELINES section before using these products. Pages 150 - 155.

# CUSTOM LIFTING



## Insulated Swivel Hook



Reduce costly handling during welding operations. Avoid shorted fork-lift batteries. Electrically insulated, the insulated hook eliminated current flow that can damage hoists and lifting equipment. Free running bearing allows easy work positioning. Use wherever electrical potentials present a hazard. Safe up to 2,000 volts and 225°F. \*Uses SKF bearing for free turning.

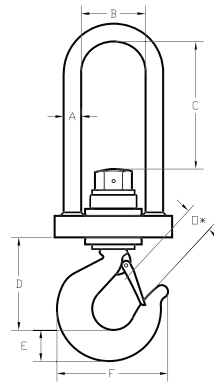

Stock #	Dimensions (Inches)							Lbs. Per Each	WLL (Lbs.)
	A	B	C	D	E	D	O*		
IS-4000	0.630	2.250	4.380	2.750	1.150	4.120	1.120	6.0	4,000
IS-8000	0.750	2.500	5.000	3.880	1.430	4.940	1.340	8.8	8,000
IS-12000	1.000	3.000	6.500	4.750	1.810	6.500	1.780	20.0	12,000
IS-20000	1.380	4.000	7.630	6.430	2.560	8.680	2.250	50.0	20,000
IS-40000	1.750	6.000	10.380	9.500	3.630	13.630	3.630	136.0	40,000

\*Dimension O is clearance under safety latch

## Magnet Stead-i Bails w/Chain Assembly

Stock #	Chain Size			Dimensions (Inches)						# of Links	Magnet Dia. (Inches)	Lbs. Per Each	WLL (Lbs.)
	Inches	MM	Reach	A	B	C	D	E	F				
MGB075	3/4	20	34.000	5.000	7.000	2.500	0.880	2.000	5.000	3	up to 43	175	65,000
MGB100	1	26	42.000	7.000	10.000	3.500	1.250	2.500	6.000	3	44 to 60	399	110,000
MGB125	1-1/4	32	52.000	8.000	12.000	4.000	1.500	3.250	8.000	3	60 and over	615	150,000

## Replacement Chains

Stock #	Chain Size (Inches)	Stock # to Fit	# of Links	Reach (Inches)	Material Dia. (Inches)	End Link Width (Inches)	End Link Length (Inches)
MGBCH075	3/4	MGB075	3	17.130	0.880	2.000	5.000
MGBCH100	1	MGB100	3	18.250	1.250	2.500	6.000
MGBCH125	1-1/4	MGB125	3	23.630	1.500	3.250	8.000

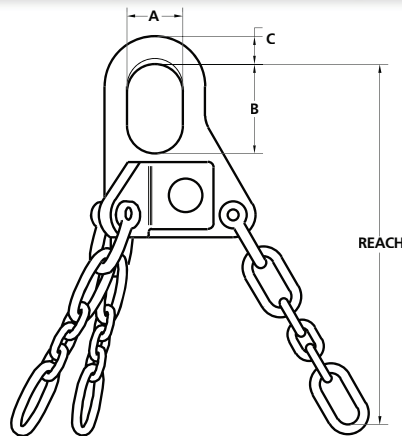



# MAGNET CHAIN ASSEMBLIES



## Accoloy® Standard Magnet Chains

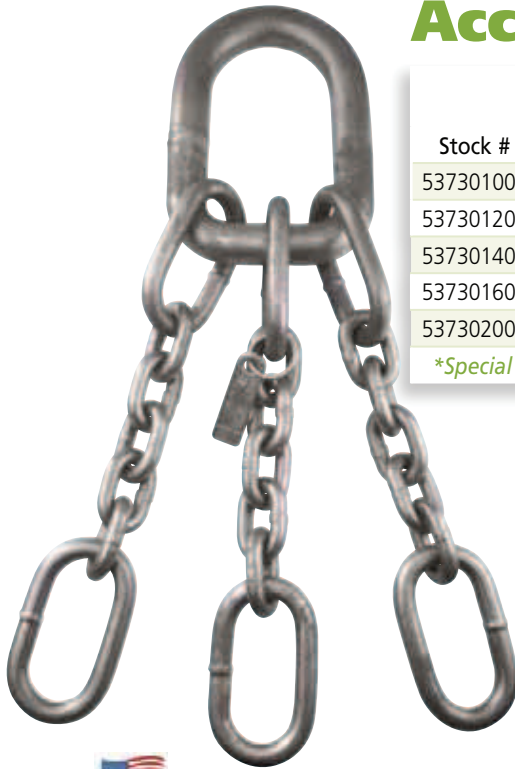

Stock #	Chain Size		Master Link Dimensions (Inches)			Sublink Dimensions (Inches)			*Reach (5 Links)	Magnet Dia.	Lbs. Per Ea.	WLL (Lbs.) @ 60°
	In.	MM	A	B	C	A	B	C				
537301000	5/8	16	1.750	6.000	10.000	0.875	2.250	5.500	30.625	up to 40	46	47,000
537301200	3/4	20	2.000	6.000	10.000	1.000	2.500	6.000	34.000	up to 45	66	73,500
537301400	7/8	22	2.250	6.500	11.500	1.000	2.500	6.000	36.875	up to 48	90	88,900
537301600	1	26	2.250	6.500	11.500	1.250	3.000	7.000	40.000	up to 60	122	123,900
537302000	1-1/4	32	2.500	6.500	12.750	1.500	3.000	7.000	45.500	60 & over	194	187,800

\*Special order reaches available

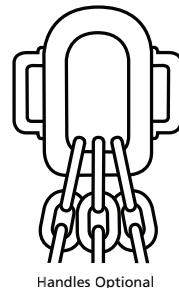

Handles Optional

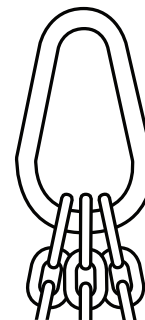

Pear Shaped Master Link Optional

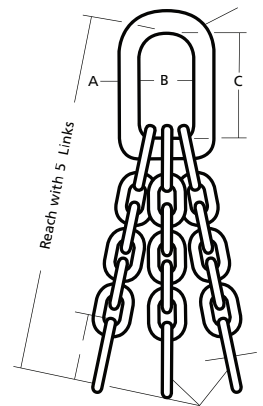

## Accoloy® Steady-Lift Magnetic Chains (3 Point Suspension)

Stock #	Chain Size		Dimensions (Inches)						# of Links	Magnet Dia. (Inches)	Lbs. Per Each	WLL (Lbs.)
	Inches	MM	A	B	C	D (Reach)	E	F				
537101600	1	26	2.250	7.000	12.000	43.000	3.000	7.000	5	up to 60	235	100,000
537102000	1-1/4	32	2.500	7.000	12.000	55.000	3.000	7.000	7	60 and over	375	150,000

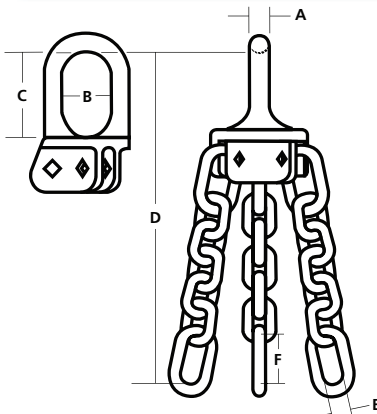

### Eliminates Costly Down Time With Lift After Lift, Built-In Dependability.

- **Ease of Use** - Designed so bail stands up while chain rests on floor, there is no wrestling with the bail for hook-up.
- **Balanced Loading** - Three point suspension offers superior stability.
- **Wearability** - Engineered and built for increased service life, with heat treated bail, pins, alloy chain and end links.
- **Less Down Time** - Easy inspection, replaceable pins, legs and bail mean more time on the job and fewer off-site repairs.

### Replacement Parts

Magnet Chain Size (Inches)	Pin	Leg	Yoke
1	537101630	537101620	537101610
1-1/4	537102030	537102020	537102010



Do not exceed Working Load Limits (WLL)! See the SAFETY GUIDELINES section before using these products. Pages 150 - 155.



# CUSTOM LIFTING



## Economy Tong



Stock #	Grip Range (Inches)	Ring ID (Inches)	Lbs. Per Each	WLL (Lbs.)
ET1004	0 - 4	2.5	6.0	1,000
ET1548	4 - 8	3.0	12.0	1,500
ET20812	8 - 12	4.0	28.0	2,000



## Safe-Grip Bar Tong



Stock #	Grip Range (Inches)	Working Height (Inches)	Lbs. Per Each	WLL (Lbs.)
BT1004	0 - 4	13.8	11.0	1,000
BT4007	4 - 7	21.5	28.0	4,000



## Standard Lifting Beam

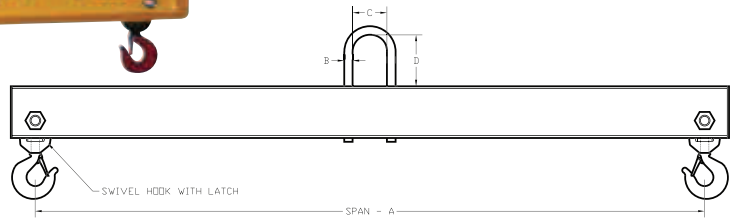

Span - "A"

Span - "A"										Upper Bail			Swivel Hook (Ton/ Material)	WLL (Lbs.)		
5 Ft.		8 Ft.		10 Ft.		12 Ft.		15 Ft.		20 Ft.		Dimensions (Inches)				
Stock #	Lbs. Per Each	Stock #	Lbs. Per Each	Stock #	Lbs. Per Each	Stock #	Lbs. Per Each	Stock #	Lbs. Per Each	Stock #	Lbs. Per Each	B	C	D		
ES15	60	ES18	88	ES110	114	ES112	165	ES115	211	ES120	332	0.63	2	4	1 / Carbon	1,000
ES25	65	ES28	119	ES210	175	ES212	205	ES215	318	ES220	429	0.75	2.5	5	1 / Carbon	2,000
ES45	102	ES48	200	ES410	232	ES412	320	ES415	463	ES420	681	1	3	6	1.5 / Carbon	4,000
ES65	120	ES68	212	ES610	292	ES612	374	ES615	517	ES620	785	1.13	4	8	1.5 / Carbon	6,000
ES85	142	ES88	250	ES810	333	ES812	435	ES815	639	ES820	1,051	1.13	4	8	2 / Carbon	8,000
ES105	189	ES108	290	ES1010	390	ES1012	512	ES1015	848	ES1020	1,117	1.38	4	8	3 / Alloy	10,000
ES155	224	ES158	392	ES1510	594	ES1512	686	ES1515	1,216	ES1520	1,751	1.5	5	10	4.5 / Alloy	15,000
ES205	293	ES208	535	ES2010	628	ES2012	1,008	ES2015	1,411	ES2020	1,788	1.75	5	10	5 / Carbon	20,000
ES305	446	ES308	787	ES3010	1,056	ES3012	1,207	ES3015	1,580	ES3020	2,474	2	6	12	7.5 / Carbon	30,000
ES405	316	ES408	736	ES4010	909	ES4012	1,155	ES4015	1,877	ES4020	3,169	2.5	6	14	11 / Alloy	40,000
ES505	439	ES508	742	ES5010	973	ES5012	1,463	ES5015	2,436	ES5020	3,422	2.75	7	16	15 / Alloy	50,000



# PEERLESS CUSTOM LIFTING DEVICES

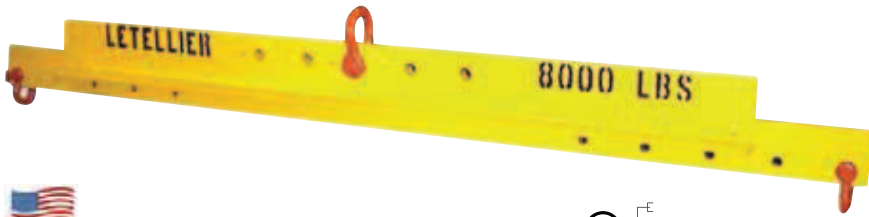

## Universal Spreader System\*

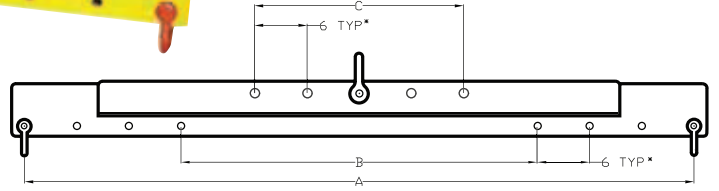
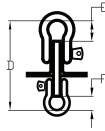

Stock #	Dimensions (Inches)									Lbs. Per Each	WLL (Lbs.)
	Max. Spread	Min. Spread	Bail Adj. Range	Headroom	Upper Shackle Clearance	Lower Shackle Clearance	Upper Shackle Trade Size	Lower Shackle Trade Size			
	A	B	C	D	E	F					
UNV023	36	18	12	5.10	1.25	0.85	7/16	1/4	20.0	250	
UNV054	46	22	16	5.70	1.35	1.34	1/2	7/16	25.0	500	
UNV160	72	36	24	6.88	1.35	1.34	1/2	7/16	65.0	1,000	
UNV260	72	36	24	7.34	2.02	1.35	3/4	1/2	115.0	2,000	
UNV460	77	41	24	10.50	2.43	1.63	7/8	5/8	195.0	4,000	
UNV880	96	48	24	12.25	2.94	1.78	1-1/8	3/4	300.0	8,000	
UNV1010	116	56	24	14.65	3.50	1.65	1-3/8	3/4	600.0	10,000	
UNV1312	140	68	36	17.13	4.00	2.02	1-1/2	7/8	880.0	13,500	

\*Supplied with (1) upper and (2) lower Screw Pin Anchor Shackles.



## Adjustable Spreader Beam\*

Stock #	Dimensions (Inches)									Lbs. Per Each	WLL (Lbs.)
	Reach	Bail Adj. Range	Headroom Required	Upper Bails			Lower Bails				
				C	D	E	F	G	H		
AB250	72	2	12	2.50	5.00	0.75	1.50	3.00	0.50	90	2,500
AB400	72	2	15	3.00	6.00	1.00	2.00	4.00	0.75	177	4,000
AB800	96	2	22	4.00	8.00	1.25	3.00	6.00	1.00	289	8,000
AB1000	120	2	26	5.00	10.00	1.50	3.00	6.00	1.00	523	10,000

\*Lower bail attachments available.

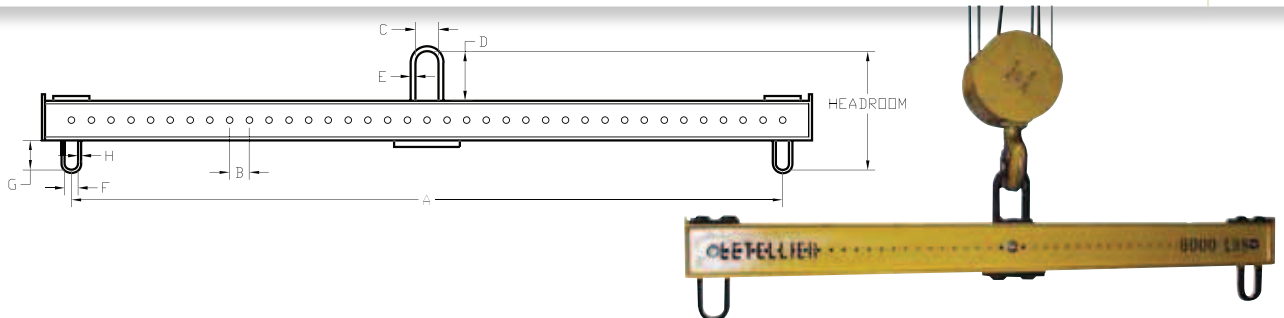

Do not exceed Working Load Limits (WLL)! See the SAFETY GUIDELINES section before using these products. Pages 150 - 155.

# CUSTOM LIFTING

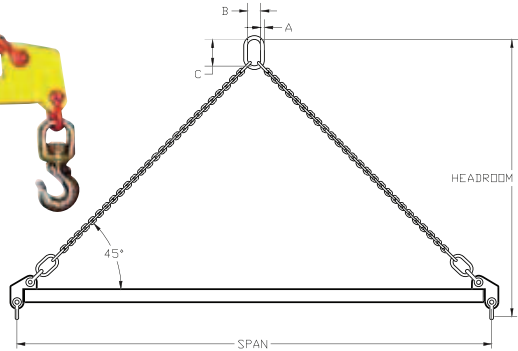

## Sling Style Spreader Beam

5 Foot, 8 Foot, 10 Foot Lengths\*

Dimensions (Inches)									Trade Size (Inches)		Upper Bail Dimensions (Inches)			Swivel Hook (Ton/ Material)	WLL (Lbs.)
5 Ft.			8 Ft.			10 Ft.									
Stock #	Head-room (Inches)	Lbs. Per Ea.	Stock #	Head-room (Inches)	Lbs. Per Ea.	Stock #	Head-room (Inches)	Lbs. Per Ea.	Upper Shackle	Lower Shackle	A	B	C		
USB0405	38	35	USB0408	56	66	USB0410	68	80	1/2	3/8	0.63	3.00	6.00	1.0 / Alloy	4,000
USB0605	38	47	USB0608	56	83	USB0610	68	101	5/8	1/2	0.75	2.75	5.50	1.5 / Alloy	6,000
USB0405	38	50	USB0408	56	88	USB0410	69	141	5/8	1/2	0.75	2.75	5.50	2.0 / Alloy	8,000
USB1205	40	66	USB1208	58	124	USB1210	70	148	3/4	5/8	1.00	3.50	7.00	3.0 / Alloy	12,000
USB2005	43	134	USB2008	61	185	USB2010	73	210	1	7/8	1.25	4.38	8.75	5.0 / Alloy	20,000
USB2805	45	173	USB2808	63	276	USB2810	75	320	1-1/4	1	1.50	5.25	10.50	7.0 / Alloy	28,000
USB3805	46	226	USB3808	64	347	USB3810	76	402	1-3/8	1-1/8	1.50	5.25	10.50	11.0 / Alloy	38,000
USB4805	47	266	USB4808	66	389	USB4810	78	511	1-1/2	1-1/4	1.75	6.00	12.00	15.0 / Alloy	48,000
USB6805	52	378	USB6808	71	596	USB6810	83	769	1-3/4	1-1/2	2.25	8.00	16.00	22.0 / Alloy	68,000

\*Lbs Per Each = Beam only (no rigging)

## 12 Foot, 15 Foot, 20 Foot Lengths\*

Dimensions (Inches)									Trade Size (Inches)		Upper Bail Dimensions (Inches)			Swivel Hook (Ton/ Material)	WLL (Lbs.)
12 Ft.			15 Ft.			20 Ft.									
Stock #	Head-room (Inches)	Lbs. Per Ea.	Stock #	Head-room (Inches)	Lbs. Per Ea.	Stock #	Head-room (Inches)	Lbs. Per Ea.	Upper Shackle	Lower Shackle	A	B	C		
USB0412	80	116	USB0415	98	143	USB0420	129	258	1/2	3/8	0.63	3.00	6.00	1.0 / Alloy	4,000
USB0612	80	162	USB0615	98	199	USB0620	129	260	5/8	1/2	0.75	2.75	5.50	1.5 / Alloy	6,000
USB0412	81	166	USB0415	99	202	USB0420	129	260	5/8	1/2	0.75	2.75	5.50	2.0 / Alloy	8,000
USB1212	82	173	USB1215	100	286	USB1220	131	344	3/4	5/8	1.00	3.50	7.00	3.0 / Alloy	12,000
USB2012	85	242	USB2015	103	390	USB2020	134	611	1	7/8	1.25	4.38	8.75	5.0 / Alloy	20,000
USB2812	88	335	USB2815	106	520	USB2820	136	772	1-1/4	1	1.50	5.25	10.50	7.0 / Alloy	28,000
USB3812	88	457	USB3815	107	629	USB3820	137	908	1-3/8	1-1/8	1.50	5.25	10.50	11.0 / Alloy	38,000
USB4812	90	576	USB4815	109	768	USB4820	139	1,179	1-1/2	1-1/4	1.75	6.00	12.00	15.0 / Alloy	48,000
USB6812	95	867	USB6815	113	1014	USB6820	144	1,286	1-3/4	1-1/2	2.25	8.00	16.00	22.0 / Alloy	68,000

\*Lbs Per Each = Beam only (no rigging)



Do not exceed Working Load Limits (WLL)! See the SAFETY GUIDELINES section before using these products. Pages 150 - 155.

# PEERLESS CUSTOM LIFTING DEVICES



## Fixed Fork Pallet Lifter

Stock #	Dimensions (Inches)					Lift Bail (Inches)			Lbs. Per Each	WLL (Lbs.)
	Fork Length	Fork Height	Fork Width	Overall Width	Inside Height	Dia.	F	G		
	A	B	C	D	E					
PL130	30	1.00	2.00	20	48	0.63	2.00	4.00	245	1,000
PL136	36	2.00	2.00	25	48	0.63	2.00	4.00	260	1,000
PL142	42	2.00	2.00	25	48	0.63	2.00	4.00	339	1,000
PL148	48	2.00	2.00	25	48	0.63	2.00	4.00	415	1,000
PL230	30	2.00	3.00	25	48	0.75	2.50	5.00	285	2,000
PL236	36	2.00	3.00	25	48	0.75	2.50	5.00	355	2,000
PL242	42	2.00	3.00	25	48	0.75	2.50	5.00	380	2,000
PL248	48	2.00	3.00	25	48	0.75	2.50	5.00	500	2,000
PL336	36	2.00	3.00	25	48	0.75	2.50	5.00	445	3,000
PL342	42	2.00	3.00	25	48	0.75	2.50	5.00	465	3,000
PL348	48	2.00	3.00	25	48	0.75	2.50	5.00	630	3,000
PL436	36	2.00	3.00	25	48	1.00	3.00	6.00	565	4,000
PL442	42	2.00	4.00	25	48	1.00	3.00	6.00	700	4,000
PL448	48	2.00	4.00	25	48	1.00	3.00	6.00	720	4,000
PL636	36	2.00	4.00	25	48	1.00	3.00	6.00	745	6,000
PL642	42	2.00	5.00	27	48	1.00	3.00	6.00	945	6,000
PL648	48	2.00	5.00	27	48	1.00	3.00	6.00	1,115	6,000
PL654	54	2.00	5.00	30	54	1.00	3.00	6.00	1,215	6,000
PL836	36	2.00	5.00	27	48	1.12	4.00	8.00	990	8,000
PL848	48	3.00	5.00	27	48	1.12	4.00	8.00	1,200	8,000
PL860	60	3.00	5.00	30	60	1.12	4.00	8.00	1,490	8,000
PL1042	42	3.00	5.00	27	48	1.38	5.00	10.00	1,400	10,000
PL1048	48	3.00	5.00	30	48	1.38	5.00	10.00	1,540	10,000
PL1054	54	3.00	5.00	32	54	1.38	5.00	10.00	1,770	10,000
PL1060	60	3.00	5.00	38	60	1.38	5.00	10.00	2,150	10,000
PL1548	48	3.00	7.00	30	48	1.50	5.00	10.00	2,350	15,000
PL1560	60	3.00	7.00	38	60	1.50	5.00	10.00	3,235	15,000
PL2048	48	3.00	7.00	30	48	1.75	5.00	10.00	2,960	20,000
PL2060	60	3.00	7.00	38	60	1.75	5.00	10.00	4,320	20,000
PL2072	72	3.00	8.00	44	60	1.75	5.00	10.00	5,720	20,000
PL3048	48	3.00	8.00	38	60	2.00	6.00	12.00	5,900	30,000
PL3060	60	3.00	9.00	38	60	2.00	6.00	12.00	6,385	30,000
PL3072	72	3.50	9.00	44	60	2.00	6.00	12.00	7,885	30,000
PL4060	60	3.50	10.00	38	60	2.50	6.00	14.00	7,600	40,000
PL4072	72	3.50	12.00	44	60	2.50	6.00	14.00	9,530	40,000

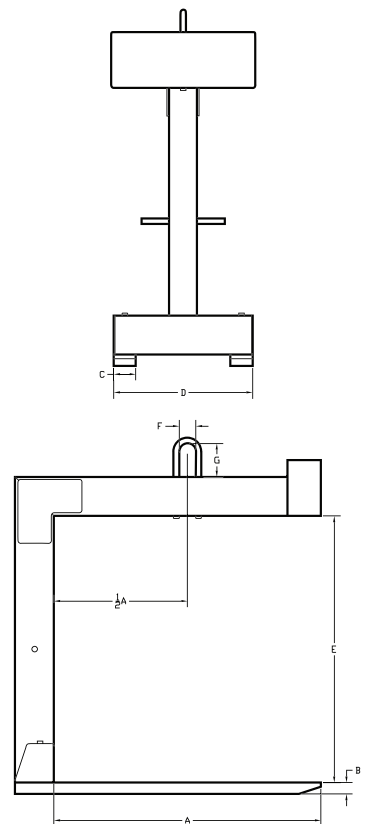

Do not exceed Working Load Limits (WLL)!  
See the SAFETY GUIDELINES section before using these products. Pages 150 - 155.



## C-Shape Coil Lifter

Stock #	Dimensions (Inches)												Lbs. Per Each	WLL (Lbs.)
	Max. Coil	Min. Coil	Inside Height	Ram Height	Ram Width	Ram Length	C/G Length	Bail Height	Bail Width	Bail Opening Width	Bail Opening Height	Head-Room		
	A	B	C	D	E	F	G	H	I	J	K	L		
CLD1036	36	24	24	6.13	4	30	18.50	1.25	1.25	4	10	40.75	440	10,000
CLD1048	48	30	24	6.88	4	39	24.50	1.25	1.25	4	10	41.50	550	10,000
CLD1060	60	36	24	4.63	4	48	30.50	1.25	1.25	4	10	42.50	790	10,000
CLD1536	36	24	24	6.88	4	30	48.50	1.50	1.50	4	10	41.75	580	15,000
CLD1548	48	30	24	4.63	4	39	24.50	1.50	1.50	4	10	42.50	730	15,000
CLD1560	60	36	24	8.38	4	48	30.50	1.50	1.50	4	10	43.25	1,010	15,000
CLD2036	36	24	24	7.88	4	30	48.50	1.75	1.75	5	10	43.00	710	20,000
CLD2048	48	30	24	8.38	4	39	24.50	1.75	1.75	5	10	43.50	940	20,000
CLD2060	60	36	24	9.13	4	48	30.50	1.75	1.75	5	10	44.25	1,140	20,000
CLD2072	72	42	24	9.88	4	57	36.50	1.75	1.75	5	10	45.00	1,520	20,000
CLD3048	48	30	30	9.38	4	39	24.50	2.00	2.00	5	10	50.75	1,300	30,000
CLD3060	60	36	30	10.13	4	48	30.50	2.00	2.00	5	10	51.50	1,710	30,000
CLD3072	72	42	34	10.88	4	57	36.50	2.00	2.00	5	10	52.25	2,010	30,000
CLD4048	48	30	34	10.38	4	39	24.50	2.25	2.25	6	14	60.00	1,760	40,000
CLD4060	60	36	34	11.38	4	48	30.50	2.25	2.25	6	14	61.00	2,100	40,000
CLD4072	72	42	34	11.88	4	57	36.50	2.25	2.25	6	14	61.50	2,590	40,000
CLD6060	60	36	34	12.63	4	48	30.50	2.50	2.50	6	18	66.50	2,910	60,000
CLD6072	72	42	34	12.88	4	57	36.50	2.50	2.50	6	18	66.75	3,690	60,000
CLD6084	84	48	34	13.88	4	66	42.50	2.50	2.50	6	18	67.75	4,290	60,000
CLD10072	72	42	36	15.38	5	57	36.50	3.00	3.00	7	20	73.75	5,480	100,000
CLD10084	84	48	36	16.38	5	66	42.50	3.00	3.00	7	20	74.75	6,250	100,000

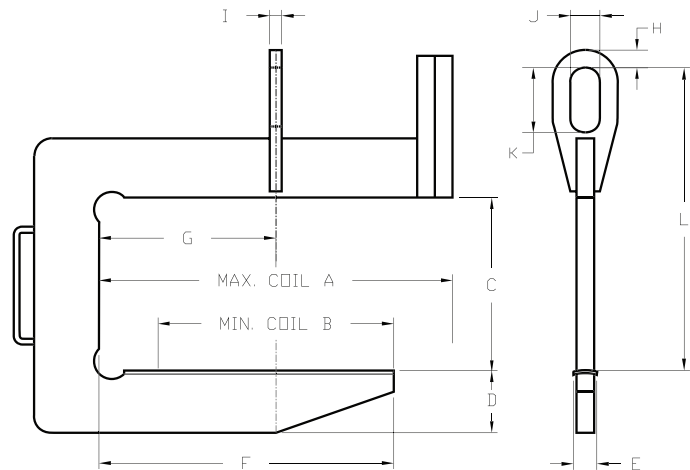

## Dual Arm Coil Lifter

Stock #	Dimensions (Inches)			Lifting Bail Dimensions (Inches)			Lbs. Per Each	WLL (Lbs.)
	Max. Coil A	Min. Coil B	Overall Height F	C	D	E		
DACL1060	60	14	64	1.50	4.00	8.00	500	10,000
DACL2048	48	14	66	2.00	4.00	10.00	530	20,000
DACL2060	60	14	66	2.00	4.00	10.00	580	20,000
DACL3048	48	18	72	2.00	4.00	10.00	540	30,000
DACL3060	60	18	72	2.00	4.00	10.00	590	30,000
DACL3072	72	18	72	2.00	4.00	10.00	625	30,000
DACL4060	60	18	78	2.50	6.00	10.00	925	40,000
DACL4072	72	18	78	2.50	6.00	10.00	1,000	40,000
DACL5060	60	18	78	2.50	6.00	10.00	955	50,000
DACL5072	72	18	78	2.50	6.00	10.00	1,030	50,000
DACL6060	60	18	78	2.50	6.00	10.00	985	60,000
DACL6072	72	18	78	2.50	6.00	10.00	1,065	60,000

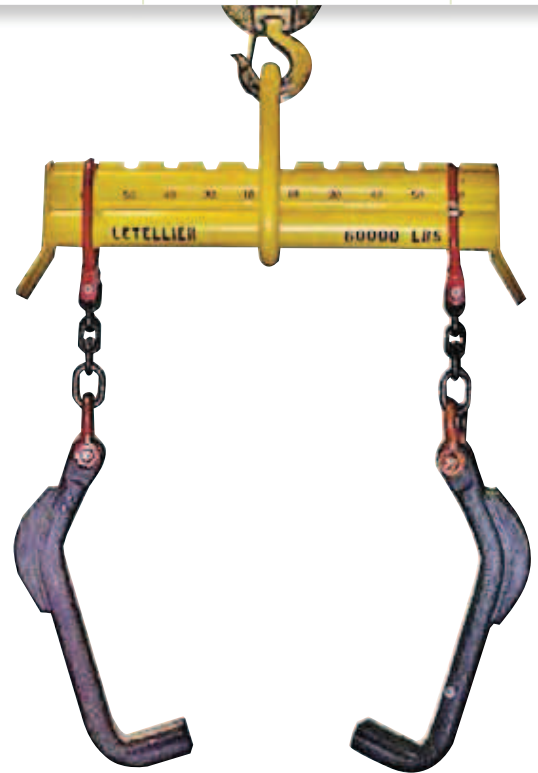
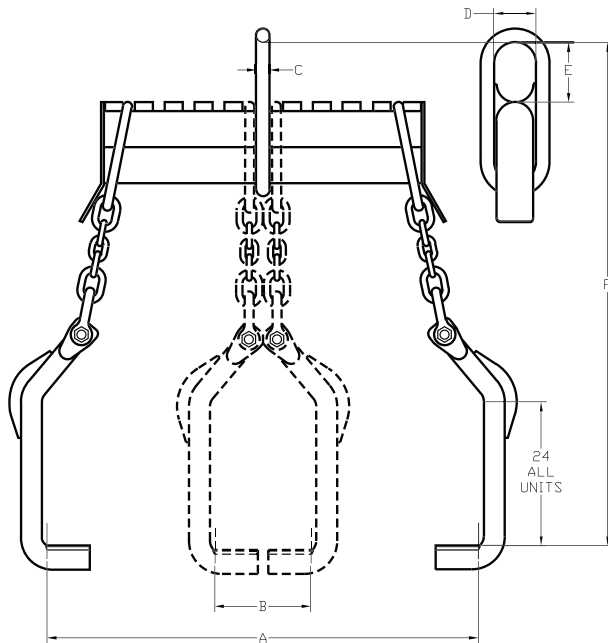

**WARNING** Do not exceed Working Load Limits (WLL)! See the SAFETY GUIDELINES section before using these products. Pages 150 - 155.

# OVERHEAD LIFTING

## Nylon & Polyester Lifting Slings

### Rated Capacity of Choker Hitch

Angle of Choke	Sling Rated Load Factor
120° ~ 180°	1.00
105° ~ 120°	0.93
90° ~ 105°	0.87

### Loss % at Angle Base Sling 6,300 Lb Basket Rating

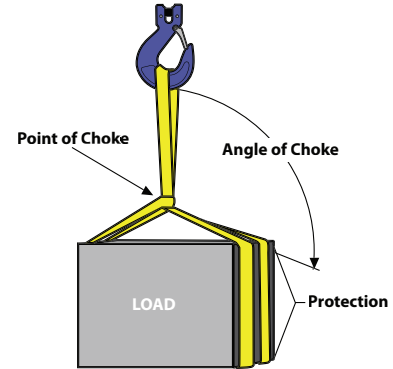
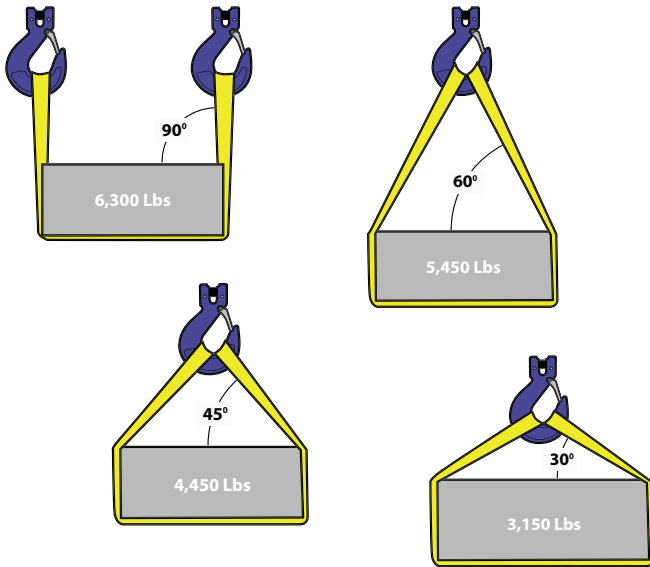

### Sling Angles & Ratings

Angle Horizontal	Loss Factor
90	1.000
85	0.996
80	0.985
75	0.966
70	0.940
65	0.906
60	0.866
55	0.819
50	0.766
45	0.707
40	0.643
35	0.574
30	0.500

## How To Order Nylon Slings

All part numbers shown in our catalog reflect the minimum length that a sling can be manufactured. We manufacture nylon slings up to 75 feet in length. To order the correct size and type of sling, please refer to the part number explanation shown below.

### SEE1702-03

Each sling part number begins with a BLACK "S".

The 2 RED letters refer to the type or style of sling.

The PURPLE number refers to the ply(s) of the sling. Slings are offered in both 1 ply and 2 ply.

The ORANGE number refers to the class of sling. Slings are all heavy duty class 7 made with 9800 lbs/in. premium nylon webbing.

The GREEN numbers refer to the width of the sling, preceded by a 0. Slings are available from 1 inch to 6 inches or 01~06.

The BLUE numbers refer to the length of the sling (03 is a 3 foot sling). Slings are available in lengths from 3 to 75 feet (03~75).

Abbreviation	Description	Type
TC	Choker	I
TT	Double Triangle	II
EE	Double Flat Eye	III
TW	Double Twisted Eye	IV
EN	Endless	V
RE	Reverse Eye	VI



## Nylon Web Sling Eye Treatments

The eyes of web slings are often subjected to the harsh treatment of rough crane hooks. Speciality eye treatments are available to help reduce the wear in that area, thereby extending sling life. The following photos illustrate the more common eye treatments using wear resistant webbing in various forms. Should you want non-standard eye treatments on your eye and eye web slings, please specify using the terminology below.

### SEE - Type Flat Eyes



### STW - Type Twisted Eyes

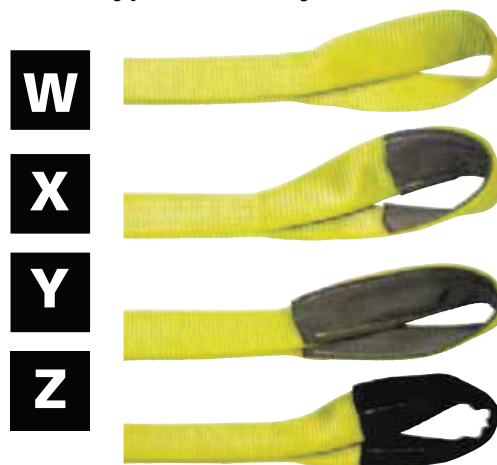

Textured nylon wear resistant webbing is standard for these eye treatments.

Tapering Eyes - As a standard practice, the eyes or bearing points of sling Types 3 and 4 are tapered to accommodate a crane hook on slings that are 3" and wider. Untapered eyes are available upon request. Type 5 (Endless) slings are NOT tapered unless specified on order.



## Loop Eyes

Recommended minimum loop eye length and suggested loop eye width for type III, IV and VI web slings are listed in the following tables.

Sling Web Width		Recommended Minimum		Suggested Loop Eye Width	
Inches	MM	Inches	MM	Inches	MM
1	25	6	152	1	25
2	51	8	204	2	51
3	76	8	204	1 1/2	38
4	102	10	254	1 1/2	38
6	152	14	355	2	51

## Increase The Life Of Your Sling:

To protect sling ends from abrasion due to use on rough surfaces or attachments, we recommend you order a choker (STC) or triangle (STT) sling. We also offer protective sleeves and buffers. The sleeves can be floating or sewn into a fixed wear position on the sling. Buffers are sewn to the web in a fixed location only. They are available in widths from 1" to 6" and lengths up to 60 feet.

When ordering sleeves for 2 ply slings, order the next size larger sleeve to fit over the added thickness of the sling.

Stock #		Width (Inches)	Length (Feet)	Weight (Lbs./Ea.)		Package
Sleeves	Buffers			Sleeves	Buffers	
SCS01	SCB01	1	1	0.04	0.02	Each
SCS02	SCB02	2	1	0.08	0.04	Each
SCS03	SCB03	3	1	0.13	0.08	Each
SCS04	SCB04	4	1	0.18	0.13	Each
SCS05	SCB05	6	1	0.30	0.16	Each



Do not exceed Working Load Limits (WLL)!  
See the SAFETY GUIDELINES section before using these products. Pages 150 - 155.





## Heavy Duty Class 7 Nylon Lifting Slings

Our flat lifting slings are manufactured from premium nylon sling webbing and include a stamped, heavy leather identification tag sewn securely to each sling. This tag is imprinted with the working load limits for the three sling configurations (vertical, choker, basket) as well as the part number and batch code which include the date of manufacture. Remember that the law requires a lifting sling to be removed from service if the capacity tag is NOT legible so with this information imprinted, you can realize a longer service life. Web slings come individually shrink-wrapped to allow them to stack neatly, display attractively and stay clean until sold.

Web slings include the latest WSTDA warning and instruction sheets in both English and Spanish.



### Choker Sling



Many popular sling sizes are stocked; other sizes are made to order.

Stock #		Width x Length (Inches x Feet)	Type	Weight (Lbs./Ea.)		Working Load Limit (Lbs.)					
						Vertical		Choker		Basket	
1 Ply	2 Ply			1 Ply	2 Ply	1 Ply	2 Ply	1 Ply	2 Ply	1 Ply	2 Ply
STC1702-03	STC2702-03	2 X 3	I	3.40	3.50	3,100	6,200	2,500	5,000	6,200	12,400
STC1703-03	STC2703-03	3 X 3	I	3.75	3.95	4,700	8,800	3,800	7,000	9,400	17,600
STC1704-03	STC2704-03	4 X 3	I	4.10	4.30	6,200	11,000	5,000	8,800	12,400	22,000
STC1706-03	STC2706-03	6 X 3	1	6.75	8.00	9,300	16,500	7,400	13,200	18,600	33,000

STC Slings are available in lengths from 3 to 75 feet and widths of 2, 3, 4 & 6 inches.



### Double Triangle Sling



Stock #		Width x Length (Inches x Feet)	Type	Weight (Lbs./Ea.)		Working Load Limit (Lbs.)					
						Vertical		Choker		Basket	
1 Ply	2 Ply			1 Ply	2 Ply	1 Ply	2 Ply	1 Ply	2 Ply	1 Ply	2 Ply
STT1702-03	STT2702-03	2 X 3	II	2.55	2.62	3,100	6,200	2,500	5,000	6,200	12,400
STT1703-03	STT2703-03	3 X 3	II	2.90	3.00	4,700	8,800	3,800	7,000	9,400	17,600
STT1704-03	STT2704-03	4 X 3	II	3.25	3.40	6,200	11,000	5,000	8,800	12,400	22,000
STT1706-03	STT2706-03	6 X 3	II	6.00	6.25	9,300	16,500	7,400	13,200	18,600	33,000

STT Slings are available in lengths from 3 to 75 feet and widths of 2, 3, 4 & 6 inches.



### Double Flat Eye Sling



Stock #		Width x Length (Inches x Feet)	Type	Weight (Lbs./Ea.)		Working Load Limit (Lbs.)					
						Vertical		Choker		Basket	
1 Ply	2 Ply			1 Ply	2 Ply	1 Ply	2 Ply	1 Ply	2 Ply	1 Ply	2 Ply
SEE1701-03	SEE2701-03	1 X 3	III	0.42	0.58	1,600	3,100	1,300	2,500	3,200	6,200
SEE1702-03	SEE2702-03	2 X 3	III	0.78	0.92	3,100	6,200	2,500	5,000	6,200	12,400
SEE1703-03	SEE2703-03	3 X 3	III	1.00	1.14	4,700	8,800	3,800	7,000	9,400	17,600
SEE1704-03	SEE2704-03	4 X 3	III	1.22	1.52	6,200	11,000	5,000	8,800	12,400	22,000
SEE1706-03	SEE2706-03	6 X 3	III	1.98	2.28	9,300	16,500	7,400	13,200	18,600	33,000

SEE Slings are available in lengths from 3 to 75 feet and widths of 1, 2, 3, 4 & 6 inches.



Do not exceed Working Load Limits (WLL)! See the SAFETY GUIDELINES section before using these products. Pages 150 - 155.



## Double Twisted Eye Sling



Stock #		Width x Length (Inches x Feet)	Type	Weight (Lbs./Ea.)		Working Load Limit (Lbs.)					
						Vertical		Choker		Basket	
1 Ply	2 Ply			1 Ply	2 Ply	1 Ply	2 Ply	1 Ply	2 Ply	1 Ply	2 Ply
STW1701-03	STW2701-03	1 X 3	IV	0.42	0.58	1,600	3,100	1,300	2,500	3,200	6,200
STW1702-03	STW2702-03	2 X 3	IV	0.78	0.92	3,100	6,200	2,500	5,000	6,200	12,400
STW1703-03	STW2703-03	3 X 3	IV	1.00	1.14	4,700	8,800	3,800	7,000	9,400	17,600
STW1704-03	STW2704-03	4 X 3	IV	1.22	1.52	6,200	11,000	5,000	8,800	12,400	22,000
STW1706-03	STW2706-03	6 X 3	IV	1.98	2.28	9,300	16,500	7,400	13,200	18,600	33,000

STW Slings are available in lengths from 3 to 75 feet and widths of 1, 2, 3, 4 & 6 inches.



## Endless Sling



Stock #		Width x Length (Inches x Feet)	Type	Weight (Lbs./Ea.)		Working Load Limit (Lbs.)					
						Vertical		Choker		Basket	
1 Ply	2 Ply			1 Ply	2 Ply	1 Ply	2 Ply	1 Ply	2 Ply	1 Ply	2 Ply
SEN1701-03	SEN2701-03	1 X 3	V	0.48	0.70	3,200	6,200	2,600	5,000	6,400	12,400
SEN1702-03	SEN2702-03	2 X 3	V	0.70	1.70	6,200	12,400	5,000	9,900	12,400	24,800
SEN1703-03	SEN2703-03	3 X 3	V	1.08	2.10	9,400	17,600	7,500	14,000	18,800	35,200
SEN1704-03	SEN2704-03	4 X 3	V	1.44	2.80	12,400	22,000	9,900	17,600	24,800	44,000
SEN1706-03	SEN2706-03	6 X 3	V	1.80	4.20	18,600	33,000	14,900	26,400	37,200	66,000

SEN Slings are available in lengths from 3 to 75 feet and widths of 1, 2, 3, 4 & 6 inches.



## Reverse Eye Sling



Stock #		Width x Length (Inches x Feet)	Type	Weight (Lbs./Ea.)		Working Load Limit (Lbs.)					
						Vertical		Choker		Basket	
1 Ply	2 Ply			1 Ply	2 Ply	1 Ply	2 Ply	1 Ply	2 Ply	1 Ply	2 Ply
SRE1702-03	SRE2702-03	2 X 3	VI	2.55	2.62	3,100	6,200	2,500	5,000	6,200	12,400
SRE1704-03	SRE2704-03	4 X 3	VI	2.90	3.00	6,200	11,800	5,000	8,800	12,400	22,000
SRE1706-03	SRE2706-03	6 X 3	VI	3.25	3.40	9,300	16,500	7,400	13,200	18,600	33,000

SRE Slings are available in lengths from 3 to 75 feet and widths of 2, 4 & 6 inches.



Do not exceed Working Load Limits (WLL)!  
See the SAFETY GUIDELINES section before using these products. Pages 150 - 155.



## Heavy Duty Polyester Roundslings

Our Roundslings are manufactured from high tenacity polyester filament that is wound into skeins and then assembled into a continuous loop. The fiber loop is then covered with a heavy duty seamless polyester sleeve for protection. By forming a sling in this manner it distributes the load over the entire sling length for longer life and better lifting or pulling properties than many other options. Roundsling lifting and attachment points can be rotated over 340° of the sling to extend the life of the sling. Roundslings are color coded by strength rating for quick and easy identification. All roundslings are manufactured to WSTDA specifications. All slings are individually shrink wrapped for a clean shelf display and include the latest WSTDA warning sheets in both English and Spanish languages.

- Lightweight, easy to handle and maintain.
- High strength to weight ratio for easier handling.
- Fabric material will not cause cuts or scratches on users hands.
- Soft cover will not scratch load.
- Superior resistance to UV, rot, mold & mildew.
- No loss of strength when used in water or wet environments.
- Resistant to acids (do not use in high alkaline environments).
- Minimal elongation in use of approximately 3%.
- Easily conforms to the shape of the load for better grip.
- Seamless cover tube with no sewn edge that can rupture prematurely or catch on the load.

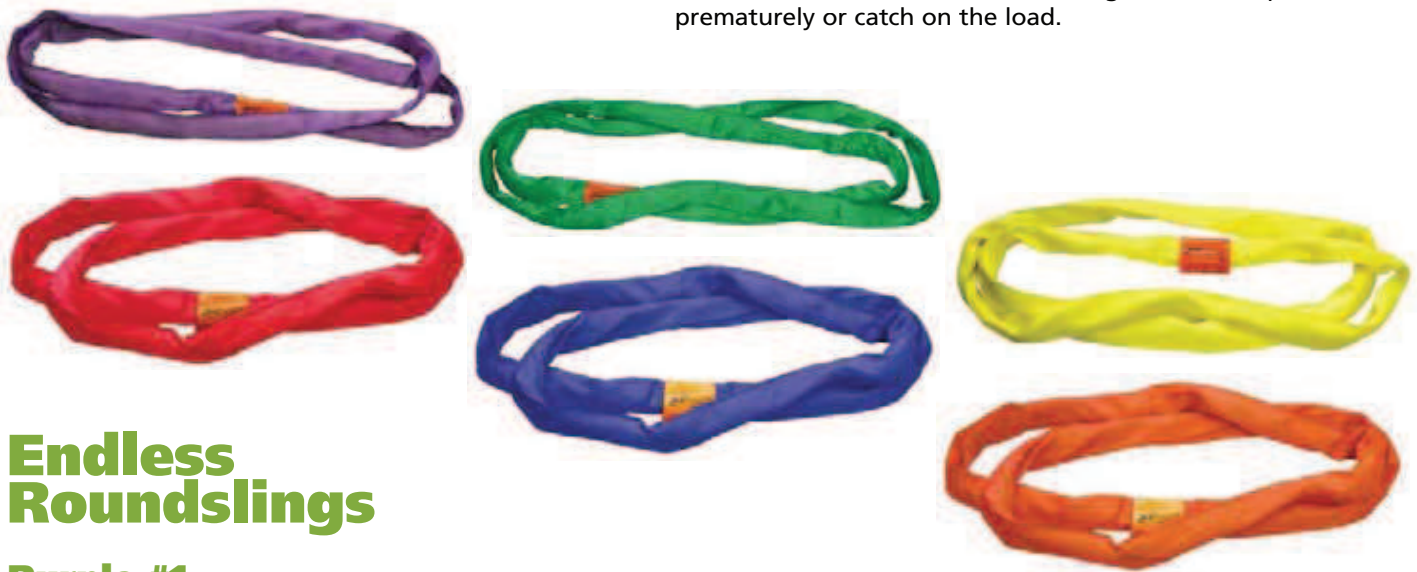

## Endless Roundslings

### Purple #1

Stock # Purple	Length (Feet)	Cover Description	Weight (Lbs./Ea.)	Qty. Per Package	Package	Working Load Limit (Lbs.)			
						Vertical	Choker	Vertical Basket	45° Vertical Basket
SREN-101-04	4	I Ply	1.07	4	Carton	2,600	2,100	5,200	3,700
SREN-101-06	6	I Ply	1.10	4	Carton	2,600	2,100	5,200	3,700
SREN-101-08	8	I Ply	1.30	4	Carton	2,600	2,100	5,200	3,700
SREN-101-10	10	I Ply	1.61	4	Carton	2,600	2,100	5,200	3,700
SREN-101-12	12	I Ply	1.92	4	Carton	2,600	2,100	5,200	3,700

### Green #2

Stock # Green	Length (Feet)	Cover Description	Weight (Lbs./Ea.)	Qty. Per Package	Package	Working Load Limit (Lbs.)			
						Vertical	Choker	Vertical Basket	45° Vertical Basket
SREN-102-04	4	I Ply	1.12	4	Carton	5,300	4,200	10,600	7,500
SREN-102-06	6	I Ply	1.63	4	Carton	5,300	4,200	10,600	7,500
SREN-102-08	8	I Ply	2.13	4	Carton	5,300	4,200	10,600	7,500
SREN-102-10	10	I Ply	2.66	4	Carton	5,300	4,200	10,600	7,500
SREN-102-15	15	I Ply	4.06	4	Carton	5,300	4,200	10,600	7,500



## Yellow #3

Stock # Yellow	Length (Feet)	Cover Description	Weight (Lbs./Ea.)	Qty. Per Package	Package	Working Load Limit (Lbs.)			
						Vertical	Choker	Vertical Basket	45° Vertical Basket
SREN-103-04	4	1 Ply	1.69	4	Carton	8,400	6,700	16,800	11,900
SREN-103-06	6	1 Ply	2.46	4	Carton	8,400	6,700	16,800	11,900
SREN-103-08	8	1 Ply	3.32	4	Carton	8,400	6,700	16,800	11,900
SREN-103-10	10	1 Ply	4.06	4	Carton	8,400	6,700	16,800	11,900
SREN-103-12	12	1 Ply	4.75	4	Carton	8,400	6,700	16,800	11,900
SREN-103-15	15	1 Ply	6.16	4	Carton	8,400	6,700	16,800	11,900
SREN-103-20	20	1 Ply	8.05	4	Carton	8,400	6,700	16,800	11,900

## Red #5

Stock # Red	Length (Feet)	Cover Description	Weight (Lbs./Ea.)	Qty. Per Package	Package	Working Load Limit (Lbs.)			
						Vertical	Choker	Vertical Basket	45° Vertical Basket
SREN-105-04	4	1 Ply	3.20	4	Carton	13,200	10,600	26,400	18,700
SREN-105-06	6	1 Ply	4.75	4	Carton	13,200	10,600	26,400	18,700
SREN-105-08	8	1 Ply	6.00	4	Carton	13,200	10,600	26,400	18,700
SREN-105-10	10	1 Ply	7.32	4	Carton	13,200	10,600	26,400	18,700
SREN-105-12	12	1 Ply	8.72	4	Carton	13,200	10,600	26,400	18,700
SREN-105-20	20	1 Ply	14.33	2	Carton	13,200	10,600	26,400	18,700

## Blue #7

Stock # Blue	Length (Feet)	Cover Description	Weight (Lbs./Ea.)	Qty. Per Package	Package	Working Load Limit (Lbs.)			
						Vertical	Choker	Vertical Basket	45° Vertical Basket
SREN-107-10	10	1 Ply	11.70	2	Carton	21,200	17,000	42,400	30,000
SREN-107-15	15	1 Ply	17.33	2	Carton	21,200	17,000	42,400	30,000
SREN-107-20	20	1 Ply	23.75	2	Carton	21,200	17,000	42,400	30,000

## Orange #10

Stock # Orange	Length (Feet)	Cover Description	Weight (Lbs./Ea.)	Qty. Per Package	Package	Working Load Limit (Lbs.)			
						Vertical	Choker	Vertical Basket	45° Vertical Basket
SREN-110-10	10	1 Ply	22.25	2	Carton	40,000	32,000	80,000	56,600
SREN-110-15	15	1 Ply	33.30	1	Carton	40,000	32,000	80,000	56,600
SREN-110-20	20	1 Ply	43.25	1	Carton	40,000	32,000	80,000	56,600
SREN-210-10	10	2 Ply	25.45	2	Carton	40,000	32,000	80,000	56,600
SREN-210-15	15	2 Ply	37.50	1	Carton	40,000	32,000	80,000	56,600
SREN-210-20	20	2 Ply	49.50	1	Carton	40,000	32,000	80,000	56,600



Do not exceed Working Load Limits (WLL)!  
See the SAFETY GUIDELINES section before using these products. Pages 150 - 155.